

Blamibo®

CONTRACTOR

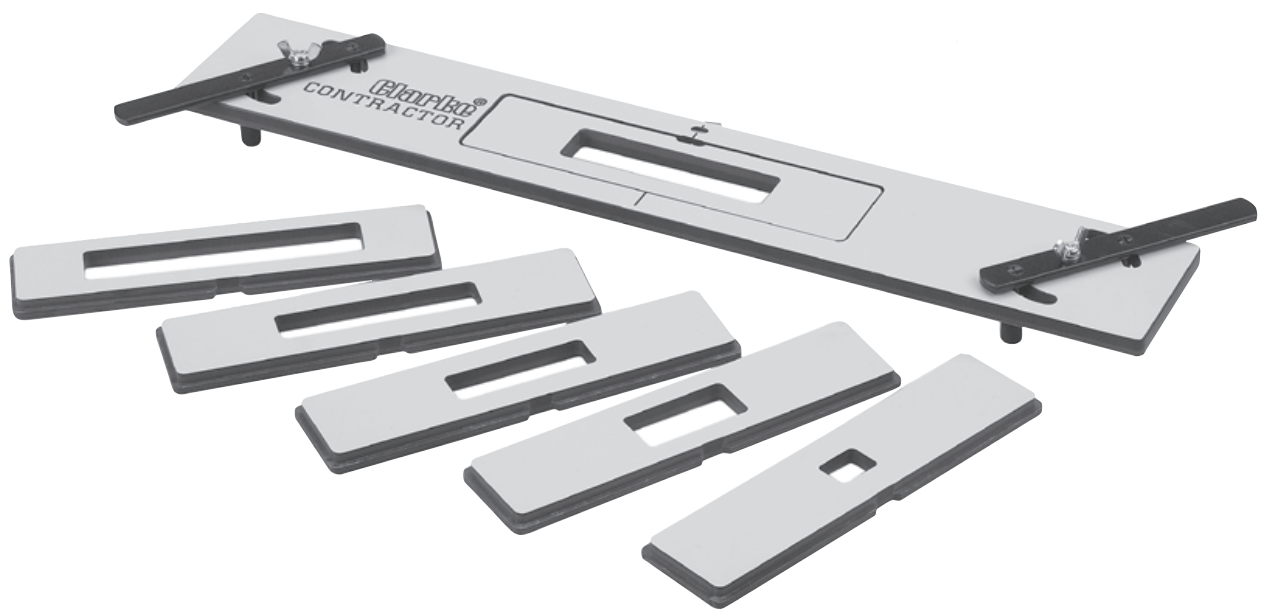

LOCK JIG

Model No: CLJ120

Part No: 6462122

OPERATION & MAINTENANCE
INSTRUCTIONS



0405

Please note that the details and specifications contained herein, are correct at the time of going to print. However, CLARKE International reserve the right to change specifications at any time without prior notice.



Thank you for purchasing this CLARKE Lock Jig

Before attempting to use the jig, please read this manual thoroughly and follow the instructions carefully. In doing so you will ensure the safety of yourself and that of others around you, and you can look forward to the jig giving you long and satisfactory service.

CLARKE GUARANTEE

This CLARKE product is guaranteed against faulty manufacture for a period of 12 months from the date of purchase. Please keep your receipt as proof of purchase.

This guarantee is invalid if the product is found to have been abused or tampered with in any way, or not used for the purpose for which it was intended.

Faulty goods should be returned to their place of purchase, no product can be returned to us without prior permission.

This guarantee does not effect your statutory rights.

Introduction

The lock jig is a self centering template used for routing out the edges of doors to accommodate a variety of popular locks and face plates. The nesting plate is complete with a clamping lever system which automatically positions the lock centrally in the door and clamps the jig ready to start routing.

Once the nesting plate is in position, a range of inserts can be added depending on the size of lock to be fitted. The inserts are used in pairs, - one for the lock body, the other for the lock face plate.

Contents

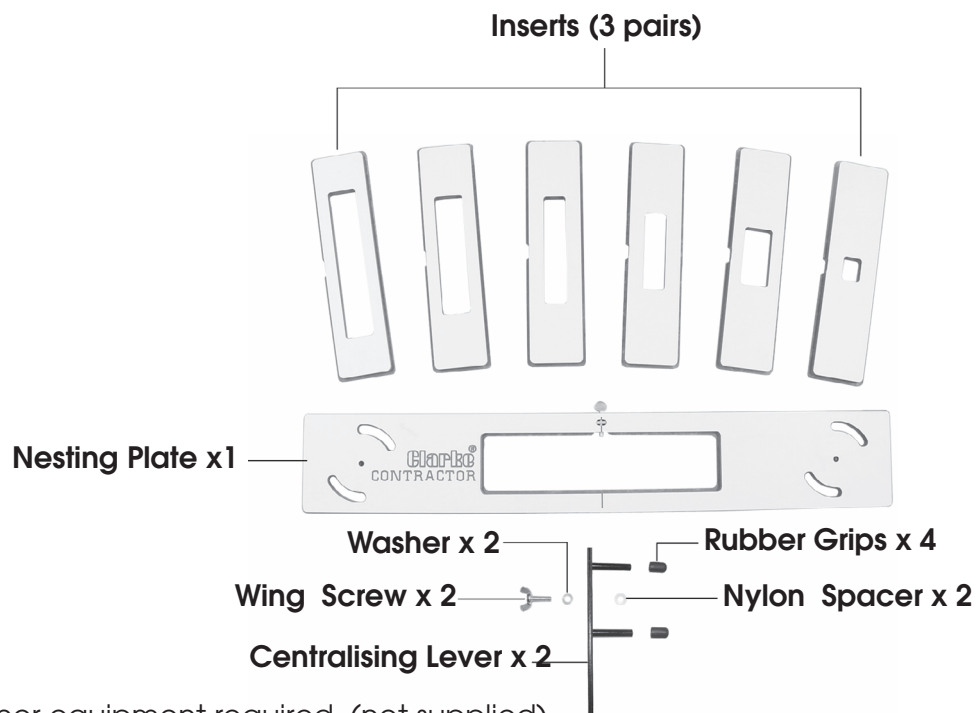

Other equipment required, (not supplied).

- ◆ Light duty router capable of plunging the depth of the lock to be fitted, also must be able to take a 16mm guide bush.
- ◆ 16mm Guide bush.
- ◆ 12.7mm (1/2") Router Cutter.

Safety Precautions



WARNING:



As with all machinery, there are certain hazards involved with their operation and use. Exercising respect and caution will considerably reduce the risk of personal injury. However, if normal safety precautions are overlooked or ignored, personal injury to the operator or damage to property, may result.

1. **ALWAYS** Learn the equipments applications, limitations and any specific potential hazards peculiar to it. Read and become familiar with the entire operating manual.
2. **ALWAYS** use a face or dust mask if operation is particularly dusty.
3. **ALWAYS** check for damage. Before using tools and equipment, any damage should be checked to ensure that it will operate properly, and perform its intended function. Check for alignment of moving parts, breakage of parts, mountings, and any other condition that may affect the equipments operation. Any damage should be properly repaired or the part replaced. If in doubt, **DO NOT** use. Consult expert advice.
4. **ALWAYS** disconnect power tools from the electric supply before servicing and when making adjustments or changing accessories etc.
5. **ALWAYS** wear safety goggles, manufactured to the latest European Safety Standards. Everyday eyeglasses do not have impact resistant lenses, they are not safety glasses.
6. **ALWAYS** keep work area clean. Cluttered areas and benches invite accidents.
7. **ALWAYS** ensure that adequate lighting is available. A minimum intensity of 300 lux should be provided. Ensure that lighting is placed so that you will not be working in your own shadow.
8. **ALWAYS** keep children away. All visitors should be kept a safe distance from the work area, especially whilst working with tools particularly power tools.
9. **ALWAYS** maintain equipment in top condition. Keep tools/machines clean for the best and safest performance. Follow maintenance instructions.
10. **ALWAYS** handle with extreme care do not carry tools/machines by the electric cable, or yank the cable to disconnect it from the power supply.
11. **ALWAYS** ensure the switch is off before plugging in to mains. Avoid accidental starting.
12. **ALWAYS** concentrate on the job in hand, no matter how trivial it may seem. Be aware that accidents are caused by carelessness due to familiarity.
13. **ALWAYS** keep your proper footing and balance at all times don't overreach. For best footing, wear rubber soled footwear. Keep floor clear of oil, scrap wood etc.
14. **ALWAYS** seek assistance when lifting heavy objects (doors and worktops etc).

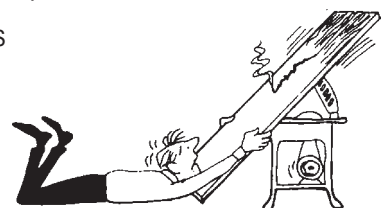
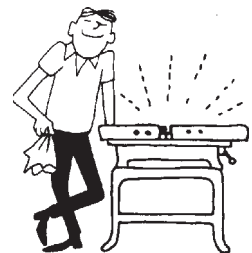
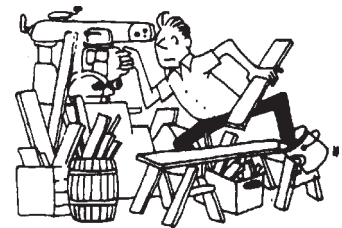

Assembly

Jig Assembly

The only assembly required is to attach the centralising levers, this is carried out as follows:

1. With the Clarke logo in the nesting plate facing upwards, insert the lever prongs into the plate slots (Fig. 1).
2. Fit nylon spacer between the lever and nesting plate (Fig. 2)
3. Fit washer on centralising lever (Fig. 3).
4. Secure with wing screw (Fig. 4).

Repeat steps 1 - 4 for other centralising lever on opposite end.



Finally turn the jig over and fit rubber grips to lever prongs, a light film of liquid soap or similar applied to the ends of the prongs will assist with this operation.

Before commencing:

ALWAYS ensure the work area is safe and secure.

ALWAYS ensure the door is secured properly, ideally using wedges or similar on both sides to prevent door moving whilst using the router etc.

ALWAYS ensure the router path is clear of any obstacles etc.

ALWAYS ensure the router power cable is clear of the jig and is of sufficient length.

ALWAYS read and understand the router instruction manual to ensure safe operation.

Using the Jig

Depending on the size of lock to be fitted etc, all that is required is to mark on the door edge the centre line of the lock position. As a general guideline the centre line would normally be 1 metre from the bottom of the door.

Once the lock position is determined, mark the centre line across the door edge (Fig. 5). This mark is used to position the jig in the correct place for routing.

Loosen both wing screws and turn levers fully anticlockwise.

Place the jig on the edge of the door, slide into position so that the centre line on the jig lines up with the marked centre line on the door edge (Fig. 6).

Turn levers fully clockwise and secure in position by tightening both wing screws (Fig. 6a), **DO NOT** overtighten.

Check Jig is in the correct position, once satisfied, carefully secure the jig to the door edge using suitable woodscrews in the securing holes (3mm \varnothing) top and bottom of the jig.

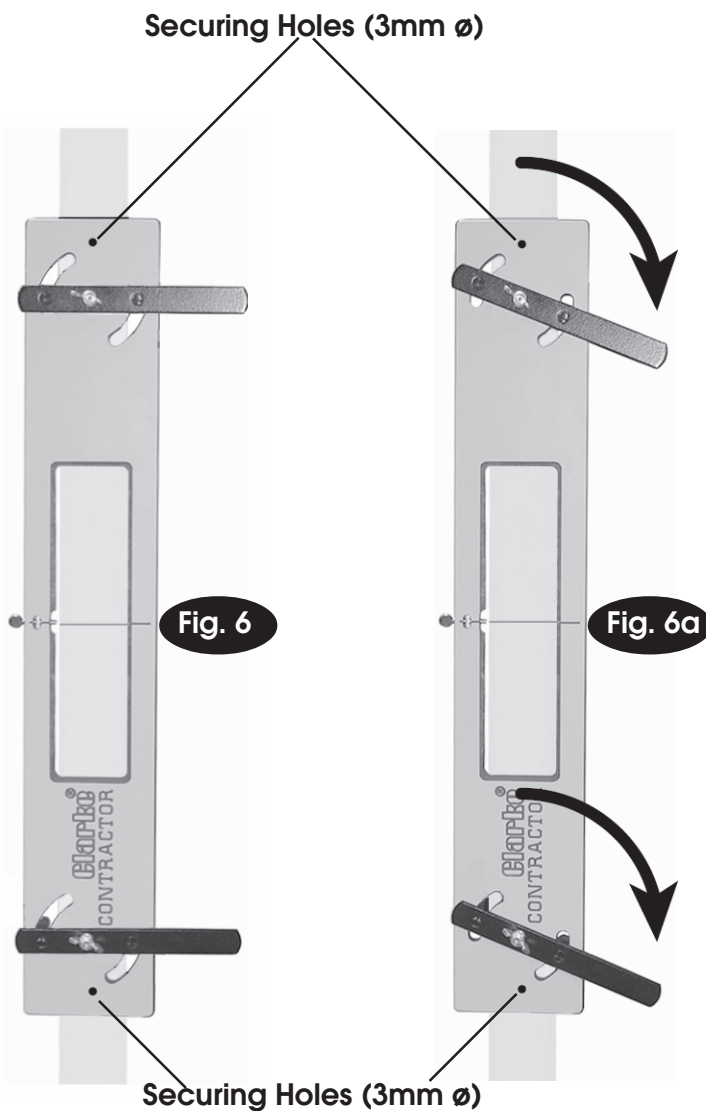
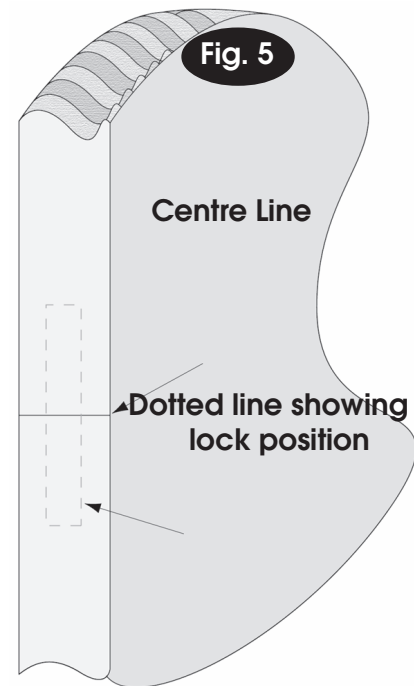

Before continuing, check that the centre line on the door is still lined up with the centre mark on the nesting plate, if not adjust until it does.

NOTE: when selecting inserts, take into account the aperture will cut approx 1.65mm smaller all round. If in doubt test on a piece of scrap first.

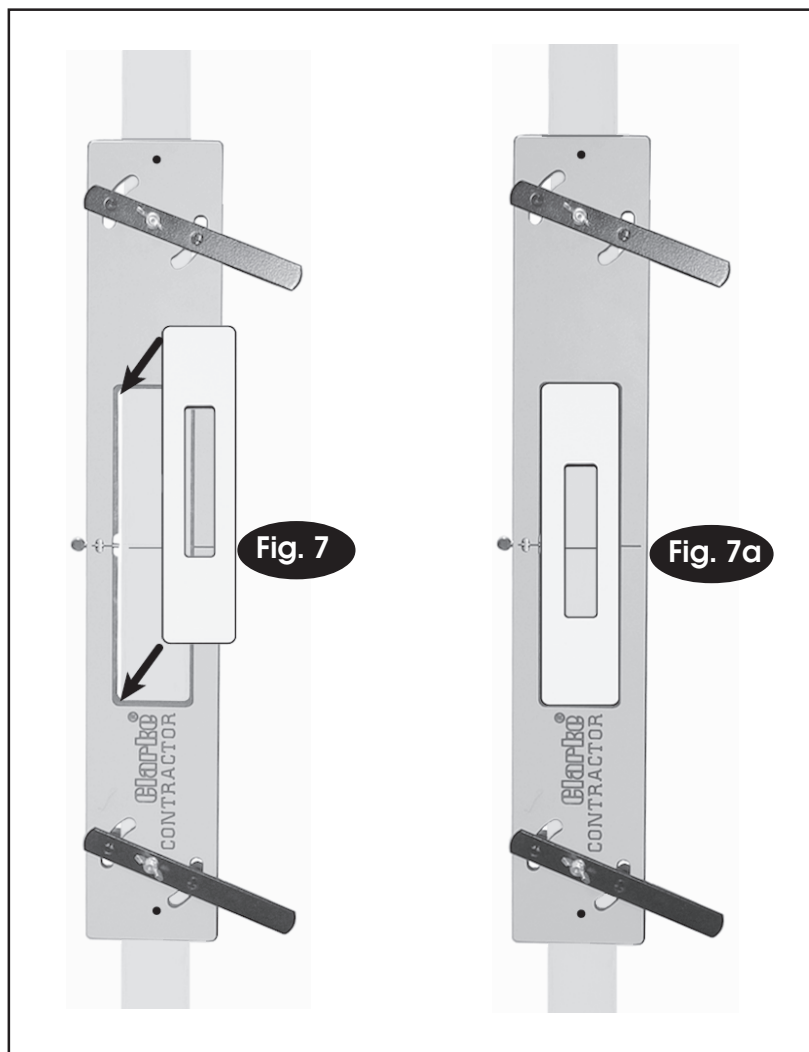

Select the correct pair of inserts for the lock to be fitted. Fit the Insert with the largest aperture (lock plate) into the nesting plate and secure in place with locking screw (Fig. 7 & 7a), ensure the insert sits flat in the nesting plate.

1. Set the router to cut to the thickness of the lock plate + the lock body plate.
2. Position the router onto the jig ensuring the cutter is not touching. Switch the router ON and plunge to the full preset depth and rout in a clockwise direction until the recess is completely cut. Switch the router OFF and wait for it to come to a full stop before lifting it from the jig.
3. Loosen the insert securing screw and remove the insert, DO NOT move the nesting plate. Square out the recess corners using a sharp chisel.
4. Fit other insert with smaller aperture (lock body) into the nesting plate and secure in position with locking screw.
5. Set the router to plunge to a maximum depth of 10mm, position the router on the jig as before. Switch ON and plunge to the full preset depth and rout in a clockwise direction until the recess is completely cut. Switch the router OFF and wait for it to come to a full stop before lifting it from the jig.
6. Increase the depth of cut a further 10mm and repeat step 5.
7. Continue to repeat steps 5 & 6 until the required depth is reached, IMPORTANT never exceed 10mm depth of cut.
8. When the required depth is achieved, switch the router OFF, wait for it to come to a complete stop, remove the router and store safely.
9. Loosen the insert securing screw and remove the insert, square off the recess corners using a sharp chisel.

A SELECTION FROM THE VAST RANGE OF

Clarke®

QUALITY PRODUCTS

AIR COMPRESSORS

From DIY to industrial. Plus air tools, spray guns and accessories.

GENERATORS

Prime duty or emergency standby for business, home and leisure.

POWER WASHERS

Hot and cold, electric and engine driven - we have what you need.

WELDERS

Mig, Arc, Tig and Spot. From DIY to auto/industrial.

METALWORKING

Drills, grinders and saws for DIY and professional use.

WOODWORKING

Saws, sanders, lathes, mortisers and dust extraction.

HYDRAULICS

Cranes, body repair kits, transmission jacks for all types of workshop use.

WATER PUMPS

Submersible, electric and engine driven for DIY, agriculture and industry.

POWER TOOLS

Angle grinders, cordless drill sets, saws and sanders.

STARTER/CHARGERS

All sizes for car & commercial use.

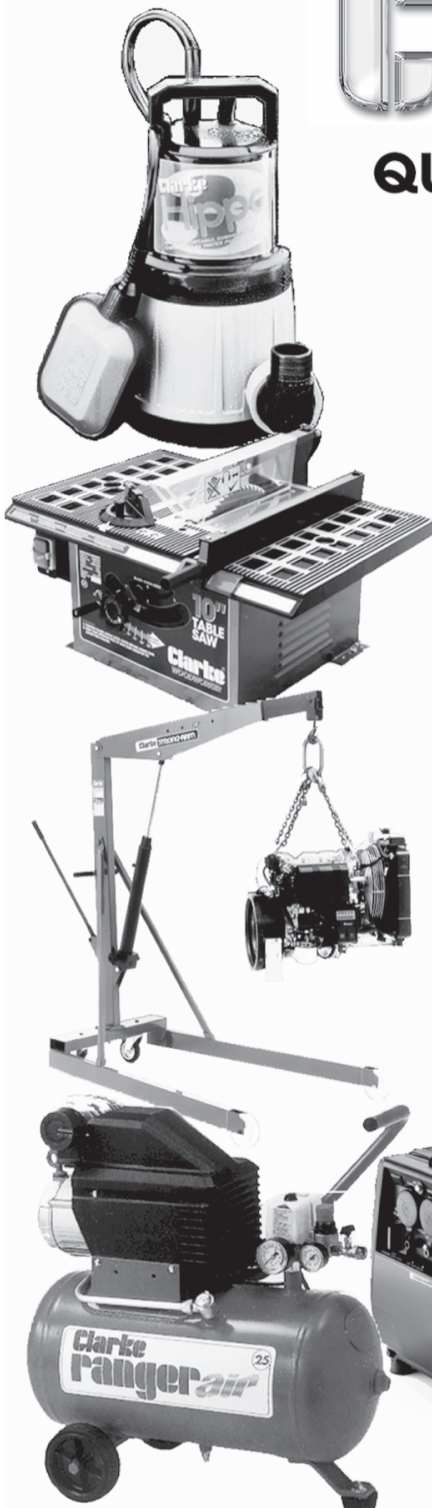

Clarke INTERNATIONAL

Hemnall Street, Epping, Essex, CM16 4LG. ENGLAND

Telephone: 01992 565333 Fax: 01992561562

e-mail: Parts@clarkeinternational.com Service@clarkeinternational.com

For spares and servicing, please contact your nearest dealer, or Clarke International on 020-8988-7400