

# Clarke<sup>TM</sup>

## WELDING SCREEN

Model No. WS2

Part No. 6000820

### ASSEMBLY INSTRUCTIONS



Your Welding Curtain comprises the following components:

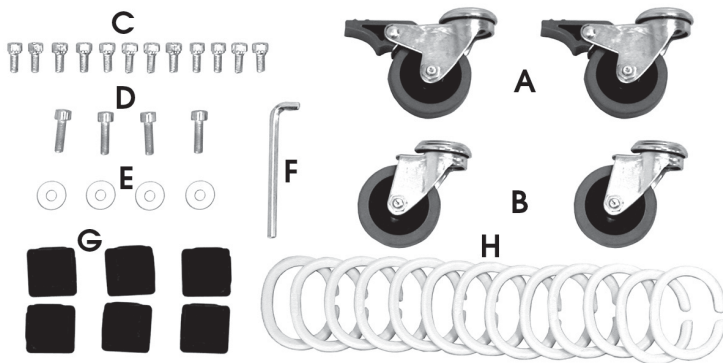

Feet .....	2 pcs
Casters with brake (A) .....	2 pcs
Casters Plain (B) .....	2 pcs
Side Members .....	2 pcs
Cross Members .....	2 pcs
Hex. socket head screws M5x10 (C) .....	12 pcs
Hex. socket head screws M5x20 (D) .....	4 pcs
Flat Washers (E) .....	4 pcs
Hex. Wrench (F) .....	1 pc
End Caps (G) .....	4 pcs
Curtain Clips (H) .....	13 pcs
Curtains .....	2 pcs

*Should there be any deficiency, please contact your Clarke dealer immediately*

**FIG.1**



1. Attach a caster to the end of each foot, using a M5x20mm hex. socket head screw with a flat washer.  
Ensure one plain caster and one with a brake device is fitted to each foot (see Fig.2).

**FIG.2**

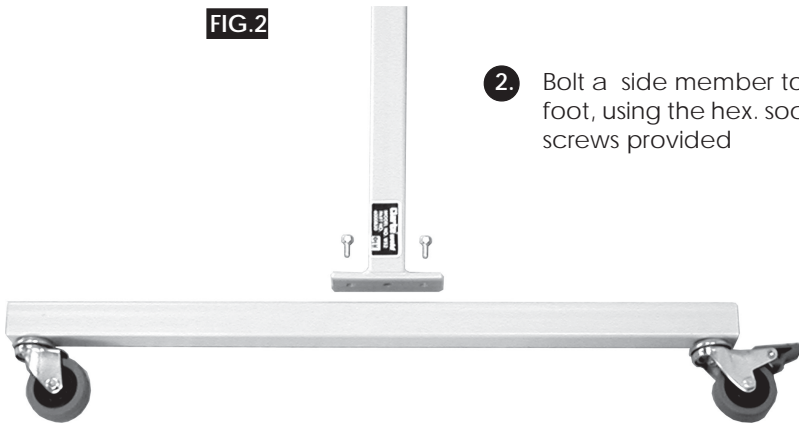

2. Bolt a side member to each foot, using the hex. socket head screws provided

**FIG.3**



3. Bolt the cross members to the side members, using the hex. socket head screws provided

**FIG.4**

4. Attach the curtains to the upper cross member using the 'C' clips provided, in the manner shown in the picture on the reverse.
5. Finally, press an end cap into the end of each foot

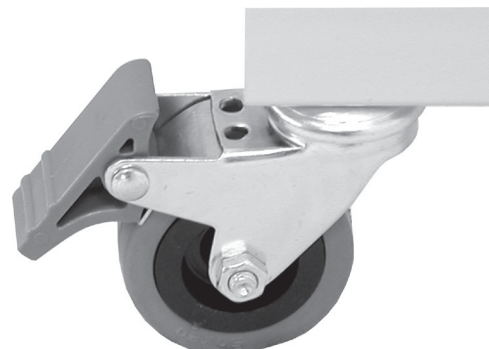

The structure may be prevented from moving by applying the brakes attached to two of the casters.

Press down with the foot, on the brake plate so that the brake is applied as shown in Fig.4