

CLARKETM

PIPE CLEANER

MODEL Nos: CPC900: Part No: 4501120
 CPC1800: Part No: 4501125

Thank you for purchasing this CLARKE Pipe Cleaner. Please take note of the following instructions in order to gain the most from the product.

This Pipe Cleaner may be used in any situation to help unblock pipes, and lavatory bowls.

When attempting to unblock a lavatory bowl, firstly pull back the coil spring by holding the Hand Grip and pulling back on the Turning Handle until the end of the spring butts up against the Bowl Guard.

Place the rod into the bowl as shown in Fig.1, then turn the Turning Handle whilst pushing it down to force the coil spring around the bend as shown in Fig.2. Continue to turn the handle to unblock the pipe.

Finally, retract the coils spring again to remove the cleaner, ensuring the bowl guard rests against the bowl throughout. This will avoid the possibility of damaging or marking the bowl.

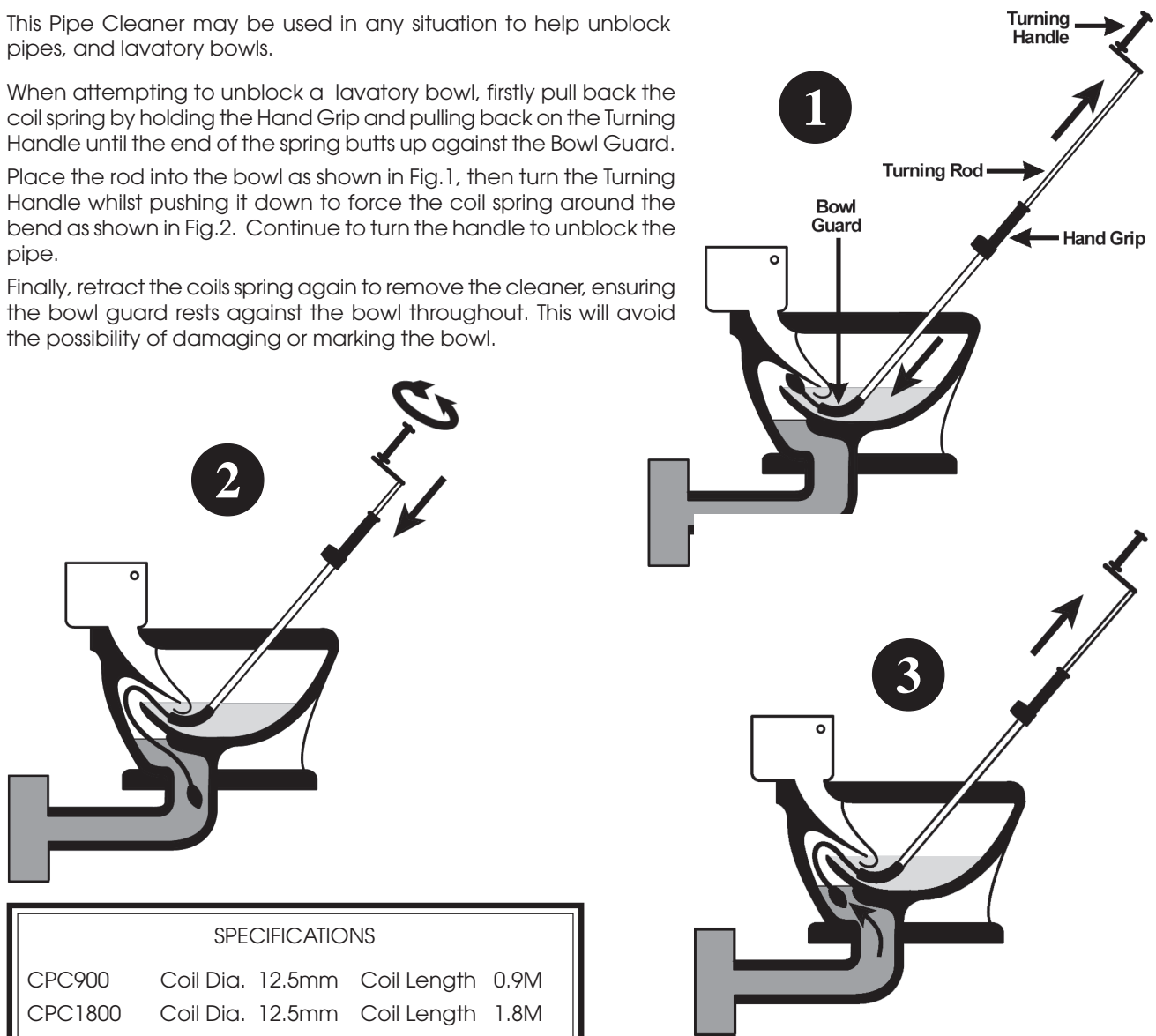

SPECIFICATIONS

CPC900	Coil Dia. 12.5mm	Coil Length 0.9M
CPC1800	Coil Dia. 12.5mm	Coil Length 1.8M