

# CLARKE®



## DIGITAL ANGLE FINDER

MODEL: DAF-1

Part No: 4500155

## OPERATING MANUAL



---

## INTRODUCTION

---

Thank you for purchasing this CLARKE product

Before attempting to use the product, it is essential that you read this manual thoroughly and carefully follow all instructions given. In doing so you will ensure the safety of yourself and that of others around you, and you can also look forward to the product giving you long and satisfactory service.

---

## GUARANTEE

---

This CLARKE product is guaranteed against faulty manufacture for a period of 12 months from the date of purchase. Please keep your receipt as proof of purchase.

This guarantee is invalid if the product is found to have been abused or tampered with in any way, or not used for the purpose for which it was intended.

Faulty goods should be returned to their place of purchase, no product can be returned to us without prior permission.

This guarantee does not effect your statutory rights.

---

## ENVIRONMENTAL PROTECTION

---



Do not dispose of this product with general household waste. All tools, accessories and packaging should be sorted, taken to a re-cycling centre and disposed of appropriately.

---

## SPECIFICATION

---

Item	Specification
Measuring range	0-360 degrees (4-settings)
Accuracy/measuring tolerance	0.1 degree
Arm length	205mm
LCD Display	12mm character height
Weight	450 grams
Dimensions (l x hx w)	265 x 50 x 23
Battery Requirement	3V Cr2032 Lithium battery

# DIGITAL ANGLE FINDER

The DAF-1 is an inovative Angle Finder with LCD display. It can be used for measuring, marking and setting angles with the following features:

- Absolute and relative measurement display
- Easy calibration & zero setting
- Lockable blade at any angle through 360 degrees
- Level bubble located on top
- Aluminium body & stainless steel arm
- 2000 hours Lithium battery life



Please note that the details and specifications contained herein are correct at the time of going to print. However, CLARKE International reserve the right to change specifications at any time without prior notice.

# OPERATING INSTRUCTIONS

## PUSH BUTTONS & LCD



- Analogue quadrant indicated
- High resolution 0.05
- “ABS” mode
- Conversion between absolute measurement and relative measurement by short press
- Holding
- Press more than 8 seconds to turn off, short press to shut off LCD

## ABS SETTING

In ABS mode the device will;

- automatically record the original ZERO position after powering off
- display always reads upright

In ABS mode, a long press on the ZERO/ABS button for 5 seconds will set the ZERO position of the movable blade.

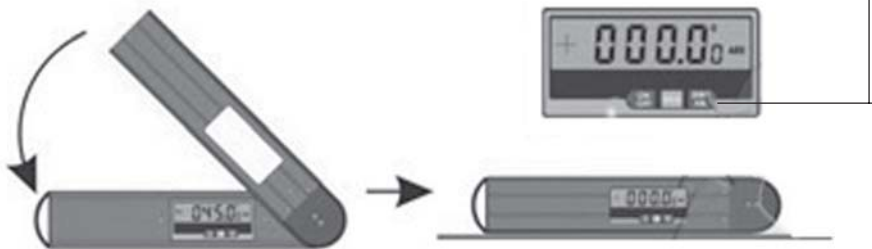

Position the moving blade in the same plane as the fixed blade.

## USE OF THE SPIRIT LEVEL

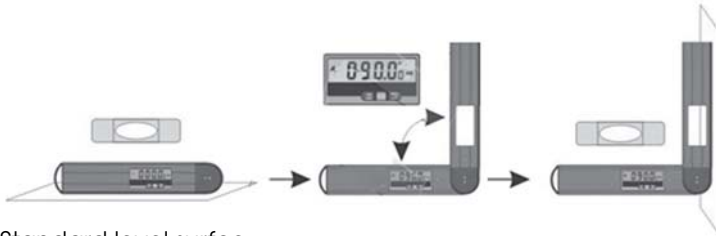

Standard level surface

Plumb surface for measuring

## USE OF THE ANALOGUE QUADRANT/MOVING BLADE

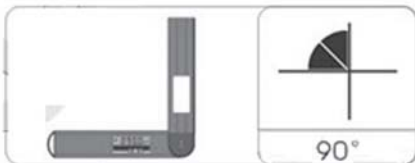
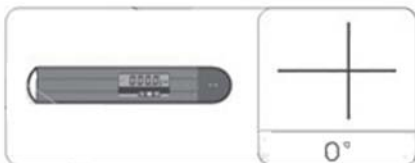

## DIGITAL READOUTS



Both internal and external angles can be measured, the reading displayed as a positive or negative angle.

## LOCKING POSITIONS FOR A SPECIFIC MEASURING RANGE

A different measuring angle can be chosen by locking the arm at one of four different locking holes. With the arm locked precisely in position, the workpiece can be marked out accurately.

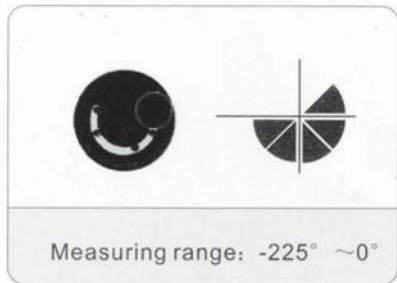
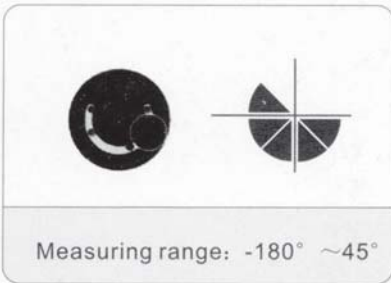
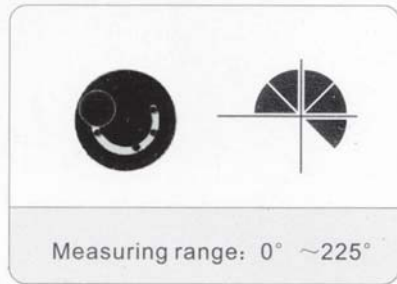
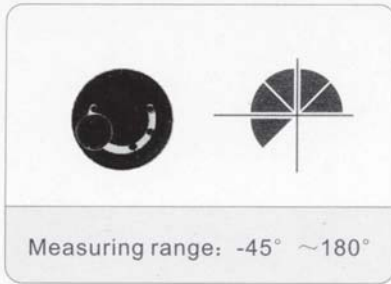

## REPLACING THE BATTERY

Press and twist with the thumb/finger tips to loosen the battery cover and remove the cover.

Replace the old battery with a new one. A single CR2032 (3volt) button cell is required.

Put the battery cover back on and twist to secure.

## GENERAL CARE OF THIS PRODUCT

If dirty, always clean the angle finder with mild liquid soap and a damp cloth. never immerse the unit in water.

# A SELECTION FROM THE VAST RANGE OF

# Clarke®

## QUALITY PRODUCTS

### AIR COMPRESSORS

From DIY to industrial, Plus air tools, spray guns and accessories.

### GENERATORS

Prime duty or emergency standby for business, home and leisure.

### POWER WASHERS

Hot and cold, electric and engine driven - we have what you need

### WELDERS

Mig, Arc, Tig and Spot. From DIY to auto/industrial.

### METALWORKING

Drills, grinders and saws for DIY and professional use.

### WOODWORKING

Saws, sanders, lathes, mortisers and dust extraction.

### HYDRAULICS

Cranes, body repair kits, transmission jacks for all types of workshop use.

### WATER PUMPS

Submersible, electric and engine driven for DIY, agriculture and industry.

### POWERTOOLS

Angle grinders, cordless drill sets, saws and sanders..

### STARTERS/CHARGERS

All sizes for car and commercial use.

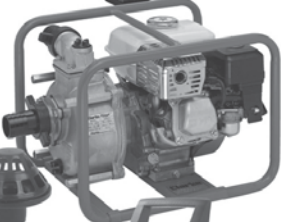

**PARTS & SERVICE: 0208 988 7400**

E-mail: [Parts@clarkeinternational.com](mailto:Parts@clarkeinternational.com) or [Service@clarkeinternational.com](mailto:Service@clarkeinternational.com)

**SALES: UK 01992 565333 or Export 00 44 (0)1992 565335**

**Clarke** INTERNATIONAL Hemnall Street, Epping, Essex CM16 4LG  
[www.clarkeinternational.com](http://www.clarkeinternational.com)