

Clarke®



OIL DRAIN CART

MODEL No: ODC8

Part No: 3051470

ASSEMBLY and OPERATING INSTRUCTIONS



0107



Thank you for purchasing this CLARKE Oil Drain Cart, which is designed to provide a means of draining oil from all sizes of vehicle, quickly and cleanly, then conveniently transporting that oil so that it may be transferred to a storage tank either by gravity or by using a suction device.

Before using this Cart, please read this leaflet thoroughly and follow the instructions carefully. In doing so you will ensure the safety of yourself and that of others around you, and you can look forward to the Drain Cart giving you long and satisfactory service.

GUARANTEE

This CLARKE product is guaranteed against faulty manufacture for a period of 12 months from the date of purchase. Please keep your receipt as proof of purchase.

This guarantee is invalid if the product is found to have been abused or tampered with in any way, or not used for the purpose for which it was intended.

Faulty goods should be returned to their place of purchase, no product can be returned to us without prior permission.

This guarantee does not effect your statutory rights.

SAFETY PRECAUTIONS

- Check to ensure the unit is in perfect condition before use - no cracks etc., which would result in oil leakage.
- When disposing of oil, it must be disposed of according to law. NEVER pour down drains etc.
- Ensure the vehicles' engine is switched OFF and the vehicle is properly parked before locating the unit beneath the drain point.
- Ensure the unit is stable before opening an oil drain.
- Be aware that the oil to be drained can be very hot. Take precautions to avoid being burned.
- Should oil be spilled, the area must be cleaned completely and sand or sawdust etc., scattered on the area, with a notice to alert people in the vicinity to the possible danger of slipping.
- ALWAYS ensure the Grille is in place as this helps to prevent splashing and to avoid spillage when transporting oil.

ASSEMBLY

Unpack the carton and check to ensure that no item was damaged during transit. Should any damage be apparent, please contact your Clarke dealer immediately.

1. Referring to the Assembly Drawing on the back page, attach the handle (#3) by fitting it inside the bracket between the two caster brackets. Secure it with a bolt (#7), washer (#6) and nut (#5).
2. Fit the Casters (#10), one to each bracket either side of the handle. Slide the caster's threaded shaft through the hole in the bracket, from beneath, and secure with a washer (#9) and nut (#8).
3. Attach the wheels (#15) to the axle brackets at the rear of the unit. Slide the axle through the bracket and secure using a washer (#9) and nut (#8). Tighten securely.
4. Before threading the valve (#12) on to the threaded spigot on the rear of the cart, wrap PTFE thread tape (not included), clockwise around the spigot thread.
5. Screw the coupler (#16) with O-Ring (#15) into the threaded outlet, and tighten. Thread on the valve so that the valve lever faces upwards.

Your Oil Drain Cart is now ready for use.

METHOD OF USE

Ensuring the vehicle is properly parked, slide the cart beneath the drain point. Ensure the drain valve lever is at right angles to the valve - i.e. in the OFF position.

Remove the vehicles' oil drain plug and allow oil to flow into the cart - take necessary precautions to avoid spillage and the effects of hot oil.

When complete, replace the oil drain plug and carefully withdraw the cart from beneath the vehicle.

To drain oil from the cart, either gravity or suction device may be used.

Simply roll the cart directly over an approved oil tank ensuring the oil drain sits directly over the opening in the tank. Open the carts' drain valve and allow the oil to drain into the tank.

A piece of hose may also be used on the end of the drain valve spigot if required.

Alternatively, if a suction pump is available, attach the inlet hose from the pump to the coupler (#16) on the cart (an adapter may be required but is not provided), and the outlet hose from the pump into the approved oil storage tank, then begin to pump either by hand, or, if an electric pump is used, ensure it is set to its lowest speed.

Be aware that some sediment will remain in the bottom of the cart. This should be cleaned out thoroughly before the cart is put away.



ASSEMBLY DIAGRAM

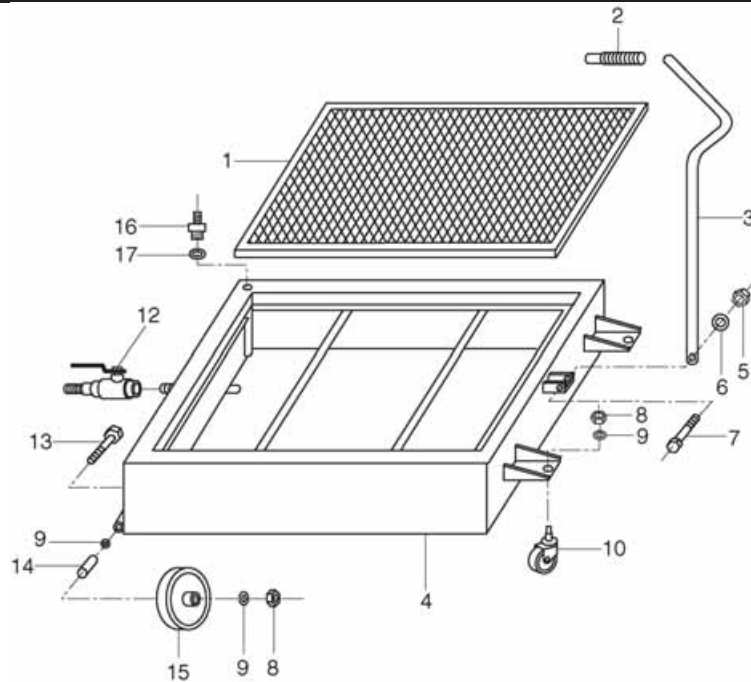

No:	Description	Part No:	No:	Description	Part No:
1	Grille	CTODC801	9	Washer	CTODC809
2	Handle Grip	CTODC802	10	Caster	CTODC810
3	Handle	CTODC803	12	Valve	CTODC812
4	Reservoir	CTODC804	13	Axle	CTODC813
5	Nut	CTODC805	14	Bearing	CTODC814
6	Washer	CTODC806	15	Wheel	CTODC815
7	Bolt	CTODC807	16	Coupler	CTODC816
8	Nut	CTODC808	17	O-Ring	CTODC817

PARTS & SERVICE CONTACTS

For Spare Parts and Service, please contact your nearest dealer,
or CLARKE International, on one of the following numbers.

PARTS & SERVICE TEL: 020 8988 7400

PARTS & SERVICE FAX: 020 8558 3622

or e-mail as follows:

PARTS: Parts@clarkeinternational.com

SERVICE: Service@clarkeinternational.com