

Clarke®



SIPHON FEED SANDBLASTER

MODEL NO: CSB34

PART NO: 7640120

OPERATION & MAINTENANCE INSTRUCTIONS

LS0309

INTRODUCTION

Thank you for purchasing this Clarke Siphon Feed Sandblaster.

Before you try to use this product, read this manual and follow the instructions carefully. In doing so you will ensure your safety and the safety of others around you. You can also look forward to a purchase that gives you long and satisfactory service.

GUARANTEE

This product is guaranteed against faulty manufacture for a period of 12 months from the date of purchase. Please keep your receipt which will be required as proof of purchase.

This guarantee is invalid if the product is found to have been abused or tampered with in any way, or not used for the purpose for which it was intended.

Faulty goods should be returned to their place of purchase, no product can be returned to us without prior permission.

This guarantee does not effect your statutory rights.

CONSUMABLES

Please be aware that certain parts of this sandblaster will wear, requiring replacement and that these parts may not be covered by your guarantee.

The wear on certain parts depends on the abrasiveness of the materials used.

Replacement parts are available from your nearest Clarke International dealer.

GENERAL SAFETY RULES



Warning: Compressed air can be dangerous. Ensure that you are thoroughly familiar with all precautions relating to the use of compressors and compressed air supplies.

-
1. Read this instruction manual before connecting the sandblaster to a compressor.
 2. Safety glasses, hood, long-sleeve shirt, gloves and a respirator should be worn during operation and clean up.
 3. During operation, do not expose the hands or skin to the blasted material, keep hands away from the nozzle.
 4. Everyone in the blasting area must also wear personal protective equipment.



Warning: Disconnect the sandblaster from the air supply before changing accessories, attempting to move the sandblaster or perform any maintenance.

-
5. Check the condition of hoses and air lines before each use.
 6. Make sure all connections are secure before use.



Warning: Do not point the sandblaster gun at anyone or objects other than the intended work object.

-
7. Abrasives used in this unit may be covered by COSHH Regulations.
 8. ALWAYS make sure there is adequate ventilation. Do not spray in confined areas.
 9. ALWAYS disconnect the gun from the air supply when the sandblaster is not in use.
 10. ALWAYS clean the gun thoroughly after use. See 'Maintenance'.
 11. ALWAYS turn off the compressor and expel all air from the air hose and gun before disconnecting the sandblasting gun.
 12. ALWAYS use appropriate air hoses and couplings and ensure that they are in good condition. If any parts are worn or damaged, they should be replaced immediately.
 13. ALWAYS hold the tool firmly and maintain good balance.
 14. NEVER carry the gun by the hose. Keep hoses away from heat, oil and sharp edges.
 15. NEVER use wet or even damp grit. Ensure the grit is completely dry.
 16. In the case of injury seek expert medical advice immediately.
 17. NEVER allow children to use or play with the sandblaster.

UNPACKING

Unpack your sand blaster and its accessories and make sure that the following items are present. Should there be any damage caused during transit contact your Clarke dealer immediately.



Drum Assembly
(HTCBS3401)



Sandblasting Gun
(HTCBS3402)



Upper Frame
(HTCBS3403)



Ceramic nozzles
Available from your Clarke
Dealer: Part no: 7640122



Lower Frame
(HTCBS3404)



Combination
Hood & Mask
(HTCBS3409)



Axle
(HTCBS3407)



Delivery Hose
(HTCBS3407)



2 x Wheels
(HTCBS3408)

Leg/Prop Stand
(HTCBS3410)



Mesh Filter
(HTCBS3405)

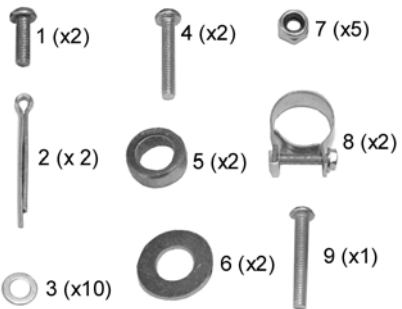

1 x Fixings Pack
(HTCBS3411)

Please dispose of any packaging responsibly. The cardboard packaging can be recycled.

ASSEMBLY

1. Slide the axle through the upper frame and lower frame as shown on the right.

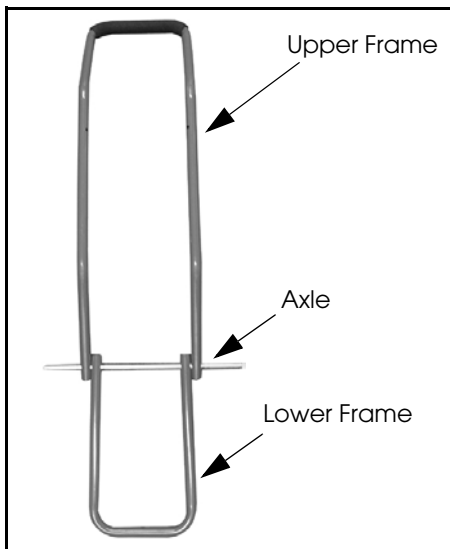

2. Slide the spacer (5) onto the axle followed by the wheel, then the thin washer (6), and secure in place using the split pin (2).
3. Repeat on the other end of the axle.

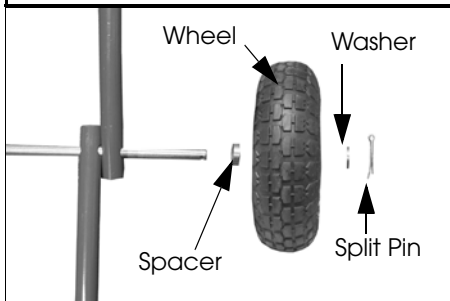

4. Attach the drum to the upper frame and secure in place using 2 bolts (4), 4 washers (3) and 2 nuts (7) to secure into place.



5. Fit the leg/prop stand to the drum and secure in place using 2 short bolts (1), 4 washers (3) and 2 nuts (7).

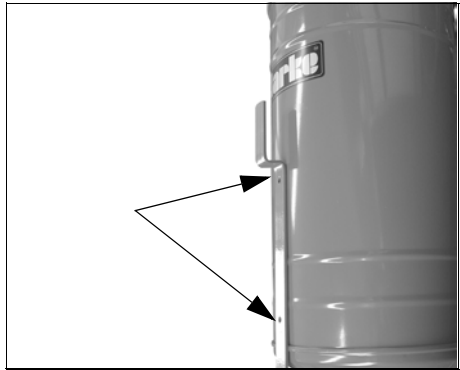

6. Secure in leg/prop stand to the lower frame using the long bolt (9), 2 washer (3) and 1 nut (7).

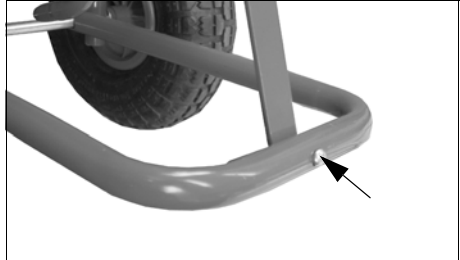

7. Place a jubilee clip (8) onto each end of the hose.

8. Firmly push the end of the hose onto the abrasive inlet on the sandblasting gun.

9. Slide one of the jubilee clips so that it is overlapping both the hose and the abrasive inlet.

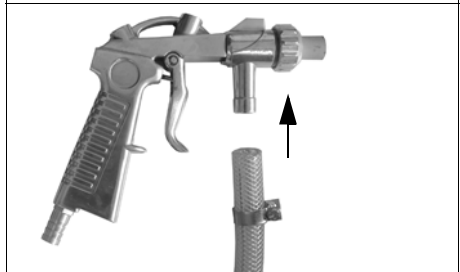

10. Tighten the jubilee clip with a screwdriver.

11. Firmly push the opposite end of the hose onto the abrasive outlet, located at the base of the drum.

NOTE: there is an air hole in the abrasive outlet - do not cover this air hole with the abrasive hose.

12. Position the remaining jubilee clip so that it is overlapping both the hose and the abrasive outlet of the drum.

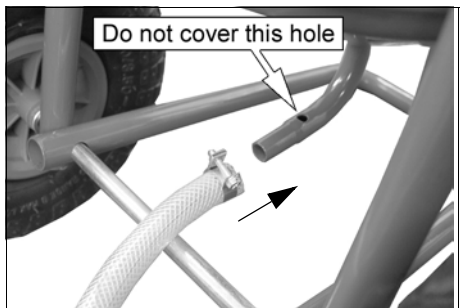

13. Tighten the jubilee clip with a screwdriver.

OPERATION

USING YOUR SANDBLASTER

Connect your sandblasting gun to a compressor (minimum 3hp capable of supplying a minimum of 10.5 CFM of air) via the 3/8" hose adaptor located at the base of the handle.

Set the air pressure on your air compressor to 100 -150 psi.

1. Connect an air hose (sold separately) from your compressor, to the hose fitting on the sandblasting gun.

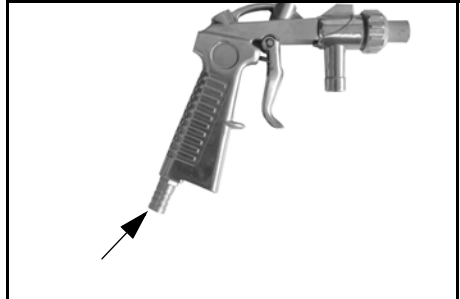

2. Make sure air hole located on the base of the abrasive tank is not covered.



3. Place the mesh filter on top of the drum and pour the blasting medium through the filter into the drum.

4. Start compressor according to the manufacturers instructions.

5. Check for leaks along all hoses and fittings. if leaks are found, turn off the compressor, disconnect the hose and repair immediately.

6. Point the sandblasting gun in a safe direction away from people, pets or anything around you that may be damaged by direct or indirect abrasive spray.

7. Press and hold the sandblasting gun trigger until abrasive medium is flowing through the nozzle.

TO STOP BLASTING

1. Release the trigger on the sandblasting gun.

MAINTENANCE

REPLACING THE NOZZLE

After 10-12 hours of blasting time the nozzle should be checked for wear. The nozzle will wear out overtime and should be replaced when the hole is no longer round or the abrasive media does not flow smoothly through it. To replace the nozzle:

1. Disconnect the sandblasting gun from the air hose.
2. Unscrew the nozzle adaptor, located at the front of the sandblasting gun.
3. Remove the old nozzle.
4. Insert new nozzle.

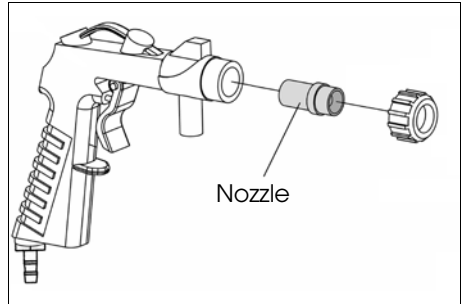

5. Replace the nozzle adaptor and firmly screw it onto sandblasting gun.
 - Keep your sandblaster clean and protect it from damage.
 - Check for worn abrasive hose and fittings. Watch for leaks, blistering, bulging or thinning of the hose.
 - Replace any parts which appear worn.

PARTS AND SERVICING

For Parts & Servicing, please contact your nearest dealer, or CLARKE International, on one of the following numbers.

PARTS & SERVICE TEL: 020 8988 7400
PARTS & SERVICE FAX: 020 8558 3622
or e-mail as follows:
PARTS: Parts@clarkeinternational.com
SERVICE: Service@clarkeinternational.com

SPECIFICATIONS

Sand Grade Type	Up to 60 Grit (Clarke AOP60)
Abrasive Material	Aluminium Oxide, Garnet Powder, Glass Bead
Drum Capacity:	34 Litres (7.5 UK gallons)
Sand Capacity: (kg/lbs)	22.6/50
Operating Pressure: (psi)	100-150
Minimum Flow Rate Req: (cfm)	10.5
Compressor Size Hp: (Minimum)	3
Gun Inlet Size:	3/8" hose adaptor fitted
Air Inlet Hose Diameter:	3/8" (10mm)
Nozzle Sizes: (mm)	4, 5, 6, 7 (Ceramic)
Dimensions (Length x Width x Height)	490 mm x 430 mm x 895 mm
Weight	8.5 Kg

A SELECTION FROM THE VAST RANGE OF

Clarke®

QUALITY PRODUCTS

AIR COMPRESSORS

From DIY to industrial, Plus air tools, spray guns and accessories.

GENERATORS

Prime duty or emergency standby for business, home and leisure.

POWER WASHERS

Hot and cold, electric and engine driven - we have what you need

WELDERS

Mig, Arc, Tig and Spot. From DIY to auto/industrial.

METALWORKING

Drills, grinders and saws for DIY and professional use.

WOODWORKING

Saws, sanders, lathes, mortisers and dust extraction.

HYDRAULICS

Cranes, body repair kits, transmission jacks for all types of workshop use.

WATER PUMPS

Submersible, electric and engine driven for DIY, agriculture and industry.

POWERTOOLS

Angle grinders, cordless drill sets, saws and sanders..

STARTERS/CHARGERS

All sizes for car and commercial use.



PARTS & SERVICE: 0208 988 7400

E-mail: Parts@clarkeinternational.com or Service@clarkeinternational.com

SALES: UK 01992 565333 or Export 00 44 (0)1992 565335

Clarke INTERNATIONAL Hemnall Street, Epping, Essex CM16 4LG
www.clarkeinternational.com