

450TE

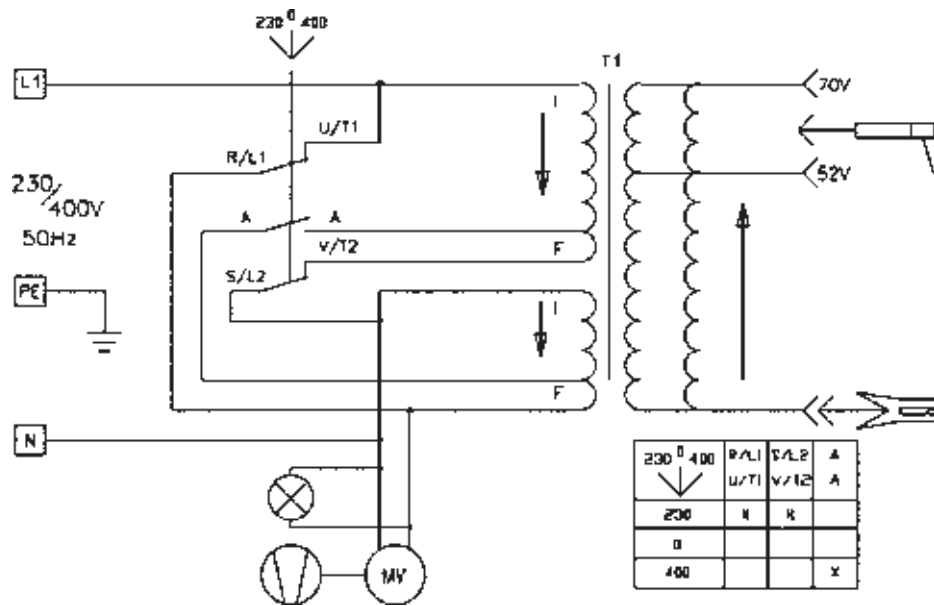

ClarkeTM weld

PARTS LISTS & WIRING DIAGRAMS

Parts & Service Contacts

For Spare Parts and Service, please contact your nearest dealer, or CLARKE International, on one of the following numbers.

PARTS & SERVICE TEL: 020 8988 7400

PARTS & SERVICE FAX: 020 8558 3622

or e-mail as follows:

PARTS: Parts@clarkeinternational.com

SERVICE: Service@clarkeinternational.com

ARC WELDERS

CE

0803

Contents

Parts Lists & Diagrams

Page No.

Ideal for light fabrication work..body repairs and the like	105E	4-5
	115E	6-7
	160E	8-9
	190E	10-11

Professional welders with high efficiency turbo fans for tough daily use in automotive and maintenance workshops	145TE	12-13
	165TE	14-15
	190TE	16-17

As above with dual 230/110V input, ideal for the hire trade for use on building sites, shop fitting etc.	145ED	18-19
--	-------------	-------

Professional welders for general fabrication work in workshops and manufacturing.	230TE	20-21
	260TE	22-23
	300TE	24-25
	350TE	26-27
	450TE	28-29

Wiring Diagrams

150E - 115E	30
160E - 190E	31
145TE - 165TE	32
190TE - 145ED	33
230TE - 260TE	34
300TE - 350TE	35
450TE	36

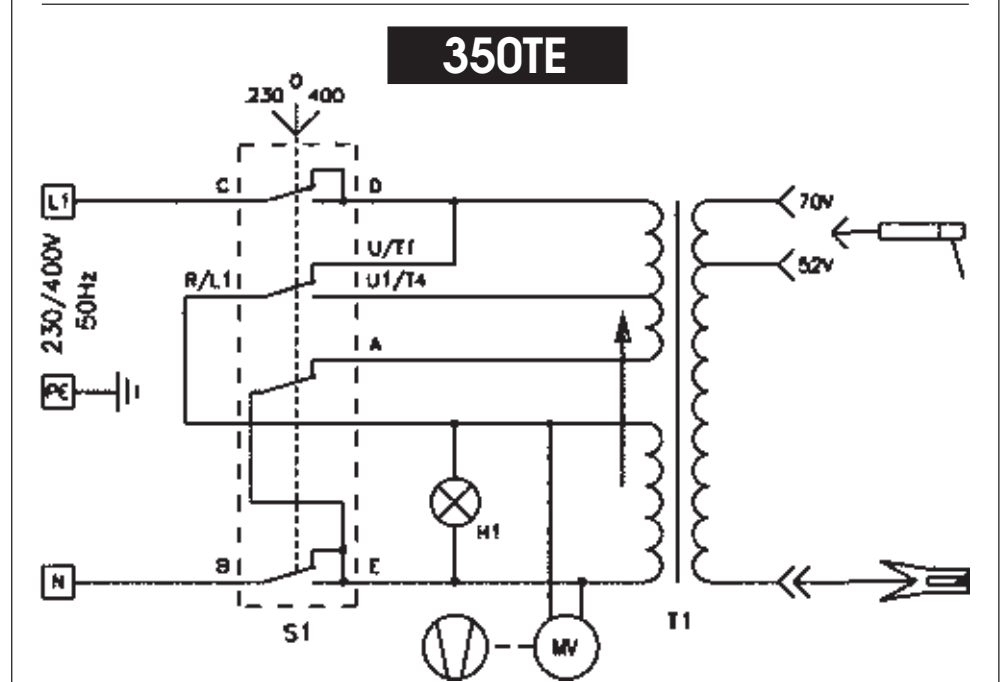
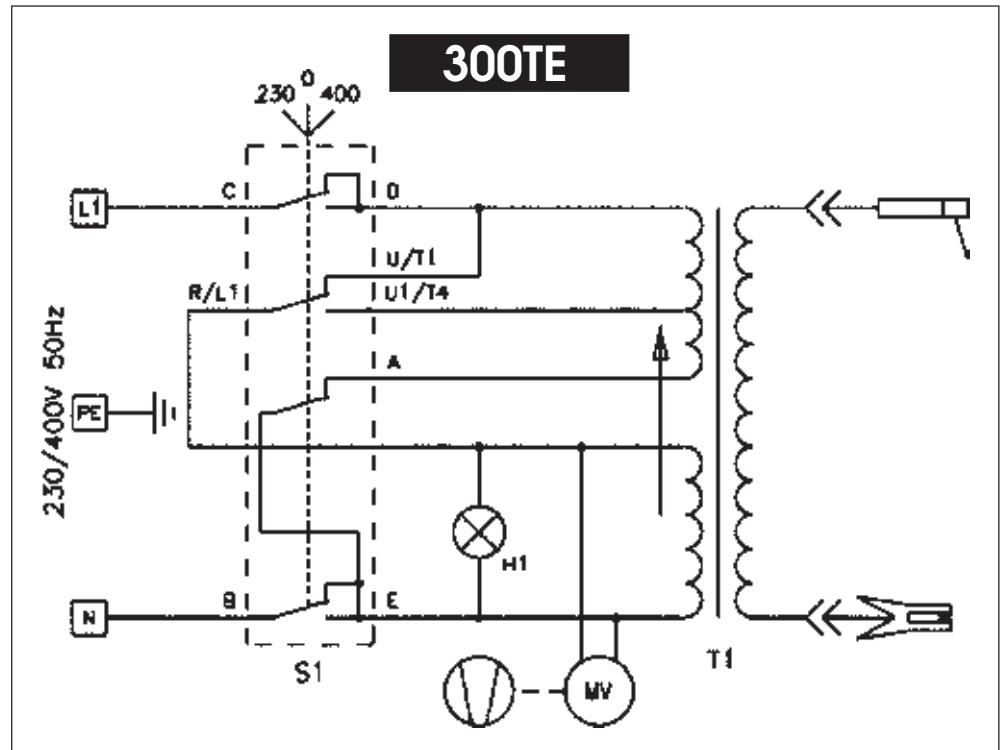

230TE

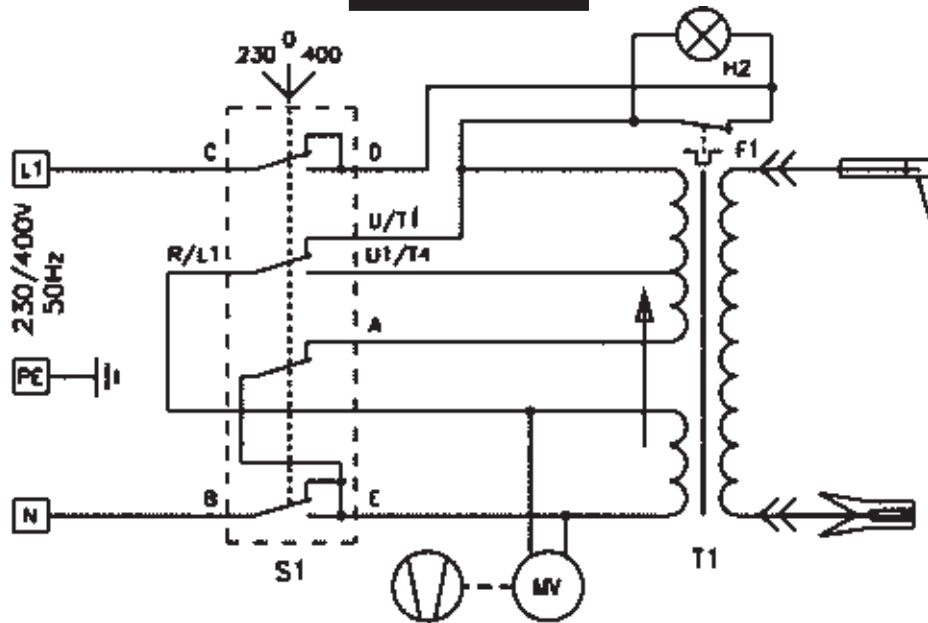

260TE

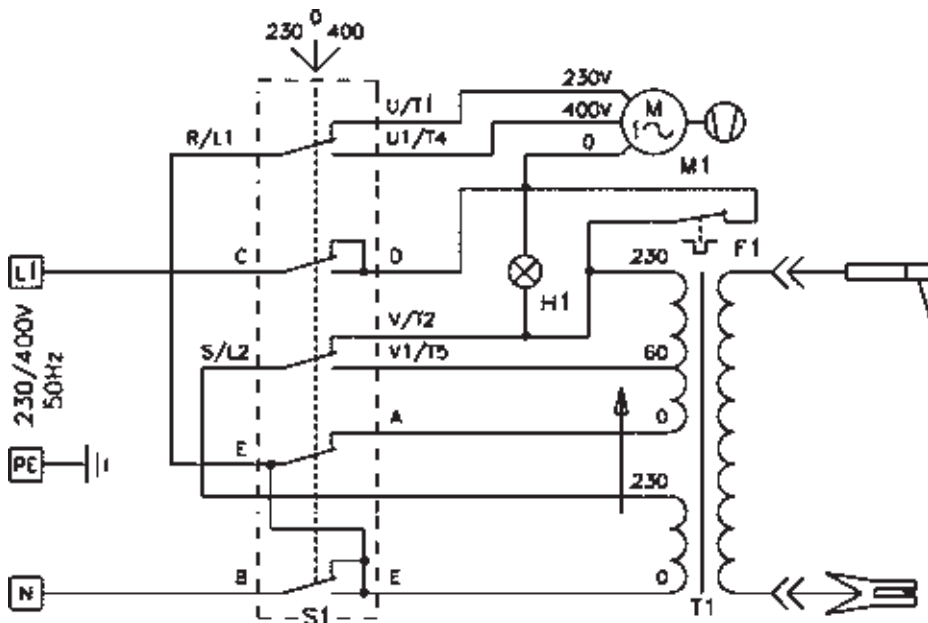

SPECIFICATIONS

Model No.	105E	115E	160E	190
Min/Max (Amps)	40-100	40-100	60-150	50-185
Electrode Dia.	1.6-2.5mm	1.6-2.5mm	1.6-3.25mm	1.6-4mm
Open Circuit Volts	48	48	48	48
Volts/Phase	230V, 1Ph	230V, 1Ph	230V, 1Ph	230/400, 1Ph
Max Input kVA	2.5	2.5	2.8	4.0
Dimensions (mm)	440x232x300	440x235x300	440x235x300	440x235x300
Weight (kg)	12.5	14.5	15.6	18.5
Part No.	6010938	6010930	6010931	6010932

Model No.	145TE	165TE	190TE	145ED
Min/Max (Amps)	40-140	35-160	35-180	40-140
Electrode Dia.	1.6-3.25mm	1.6-4.0mm	1.6-4.00mm	1.6-3.25mm
Open Circuit Volts	48	48	48	48
Volts/Phase	230V, 1ph	230/400, 1Ph	230/400, 1Ph	230/115, 1Ph
Max Input kVA	3.5	4.0	4.5	3.5
Dimensions (mm)	400x250x300	500x260x340	500x260x340	370x250x370
Weight (kg)	19	24	25	18
Part No.	6010710	6010720	6010740	6010700

Model No.	230TE	260TE	300TE	350TE	450TE
Min/Max (Amps)	40-210	50-240	55-270	55-330	40-400
Electrode Dia.	1.6-5mm	2.0-5mm	1.6-6mm	1.6-6mm	1.6-6mm
Open Circuit Volts	48	52	52	52	52
Volts/Phase	230/400V, 1ph	230/400V, 1ph	230/400V, 1ph	230/400V, 1ph	230/400V, 1ph
Max Input kVA	5.0	6.5	7.0	10	17
Dimensions (mm)	440x280x320	360x310x600	900x450x530	850x520x500	1000x520x600
Weight (kg)	29	47	68	61	88
Part No.	6010760	6010780	6011000	6011010	6011020

EASI ARC 105E

No.	Description	Part N o.
01	Welding Current Switch	EM22200006
02	Yellow Pilot-light Switch	EM22200022
03	Rear Panel	EM33700160
04	Welding Cable	EM43205011
05	Thermostat	EM22210016
06	Transformer	EM44110209
07	Handle	EM21600030
08	Upper Panel	EM33705290
09	Input Cable	EM20220068
10	Electrode Holder	EM22110011
11	Earth Cable	EM43210001
12	Earth Clamp	EM22110005
13	Plastic Mask W/Handle	EM21905018
14	Transparent Glass	EM21905020
15	Dark Glass	EM21905021
16	Hammer-brush	EM21905011
17	Cable Clamp	EM21605010
11	Cable Clamp	EM21605010
12	Transparent Glass	EM21905020
13	Dark Glass	EM21905021
14	Plastic Mask W/Handle	EM21905018
15	Hammer-brush	EM21905011
16	Input Cable	EM20220068
17	Earth Cable	EM43210001
18	Electrode Holder	EM22110011
19	Earth Clamp	EM22110005

190TE

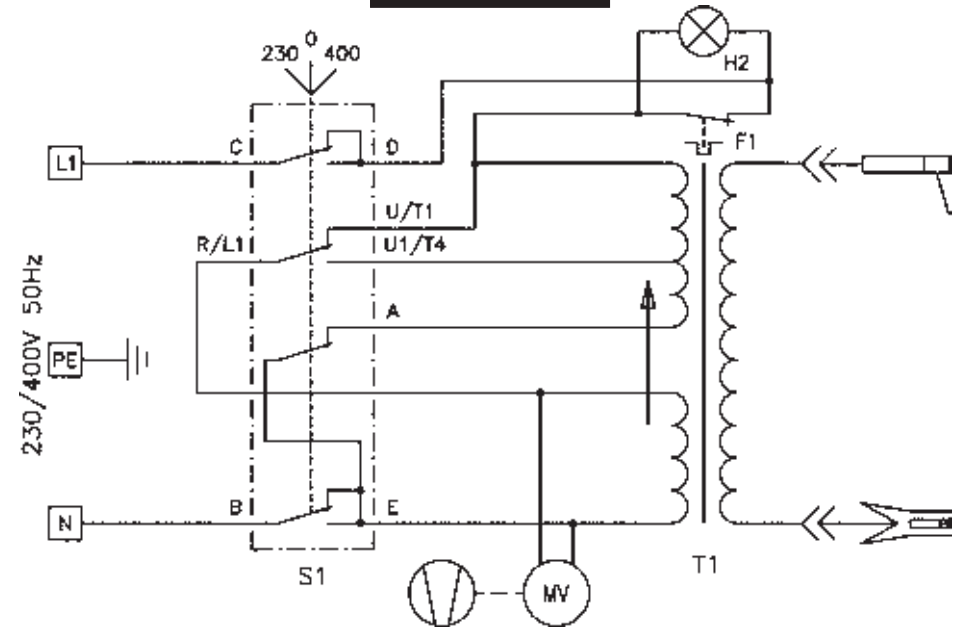

145ED

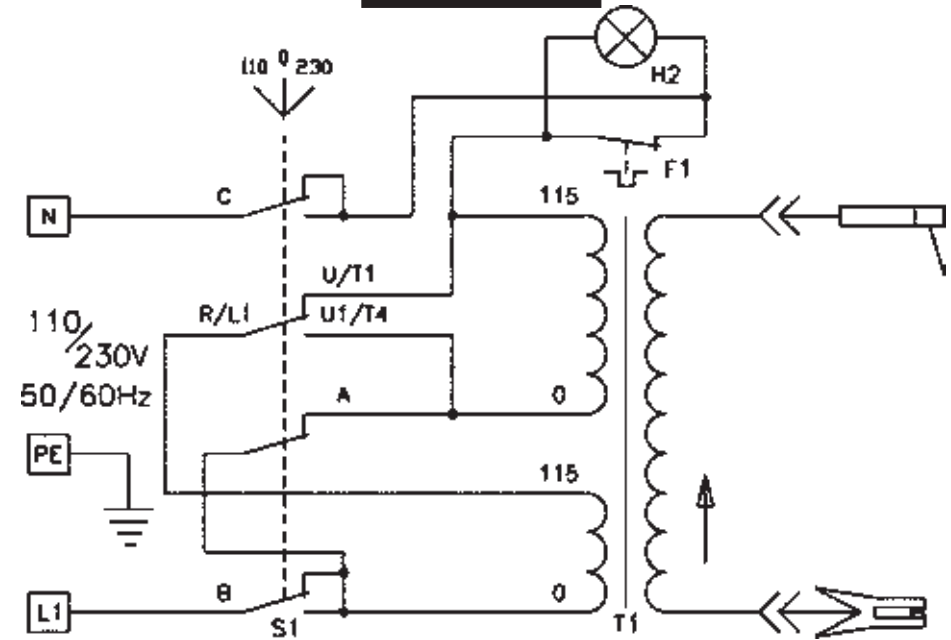

145TE

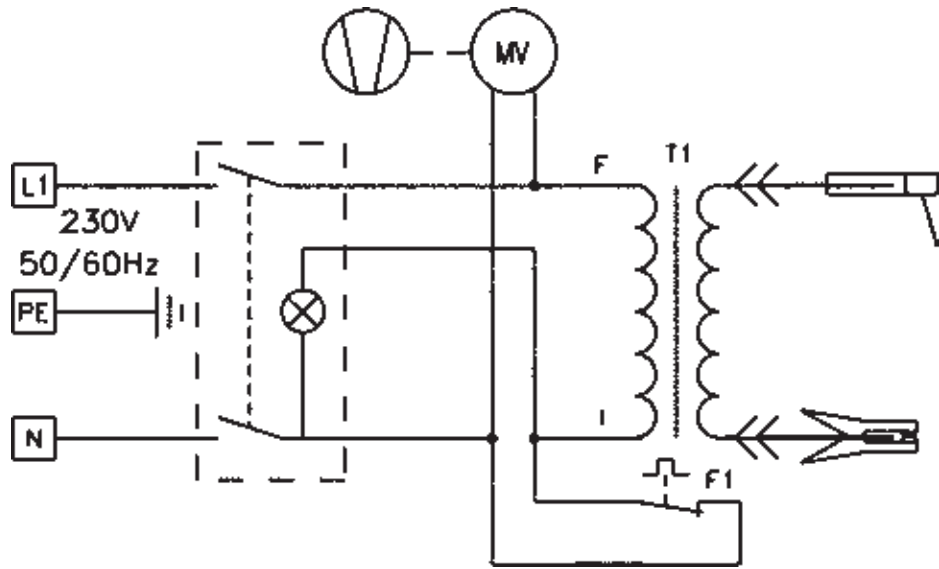

165TE



EASI ARC 105E

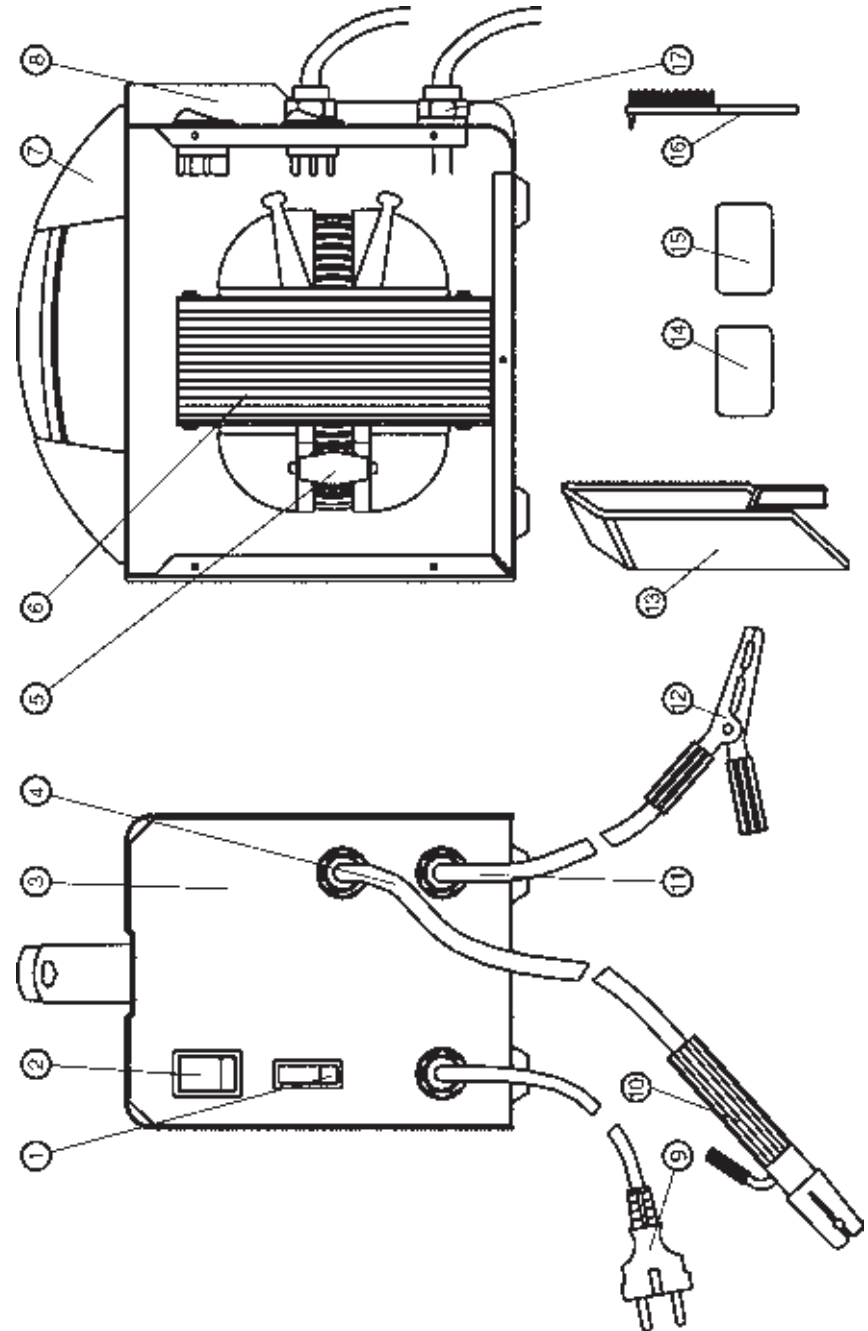

EASI ARC 115E

No.	Description	Part N o.
01	Hand-wheel	EM21800047
02	Shunt Yoke	EM33815001
03	Handle	EM21600003
04	Shunt	EM41415910
05	Transformer	EM44110211
06	Thermostat	EM22210016
07	Yellow Pilot-light Switch	EM22200022
08	Lower Panel	EM33700104
09	Welding Cable	EM43205011
10	Upper Panel	EM33705015
11	Cable Clamp	EM21605010
12	Transparent Glass	EM21905020
13	Dark Glass	EM21905021
14	Plastic Mask W/Handle	EM21905018
15	Hammer-brush	EM21905011
16	Input Cable	EM20220068
17	Earth Cable	EM43210001
18	Electrode Holder	EM22110011
19	Earth Clamp	EM22110005

160E

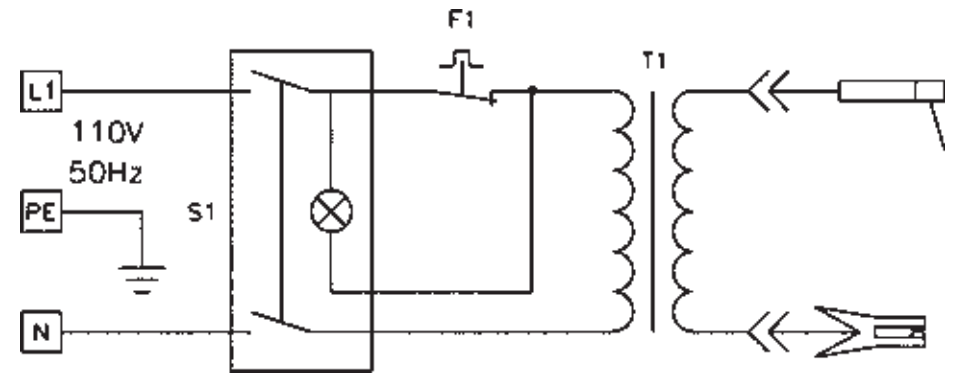

190E

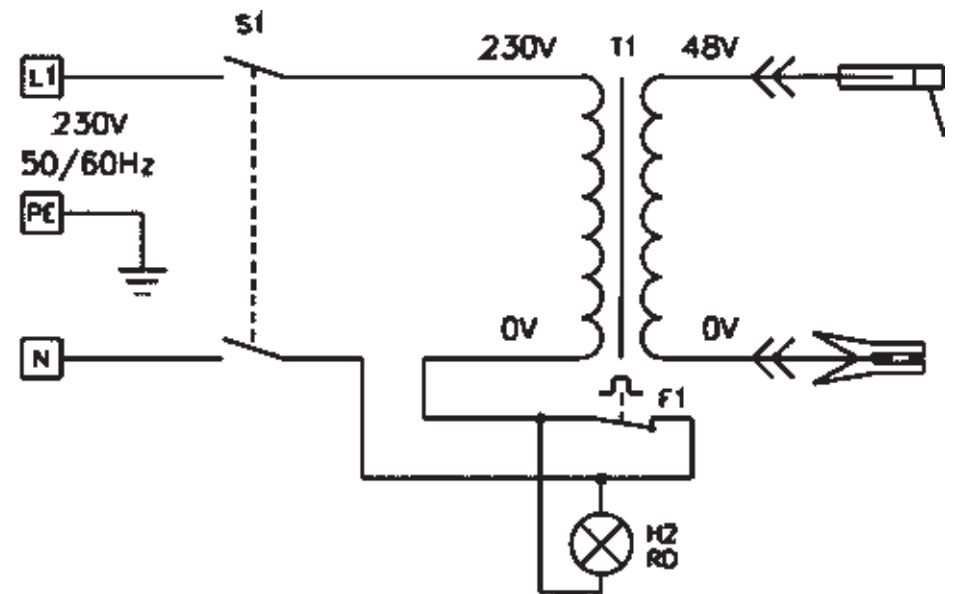

WIRING DIAGRAMS

105E

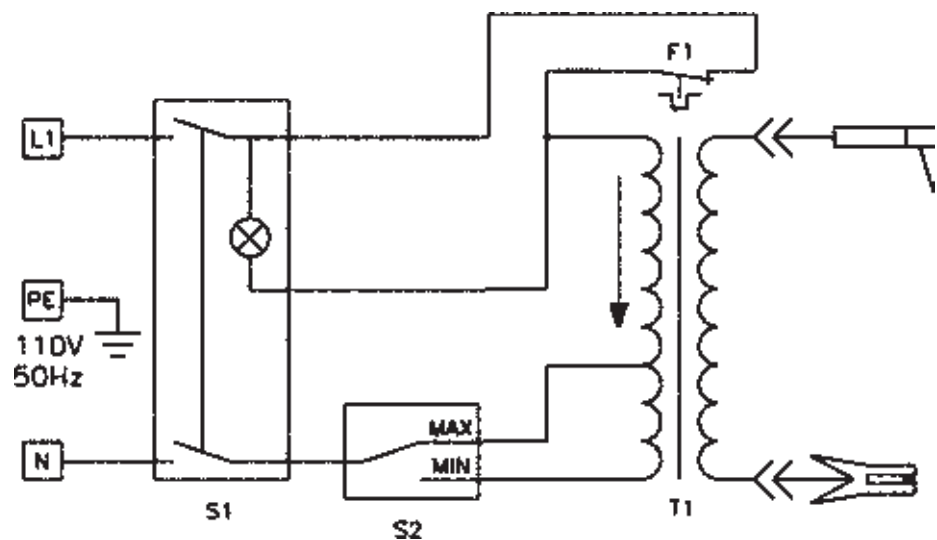

115E

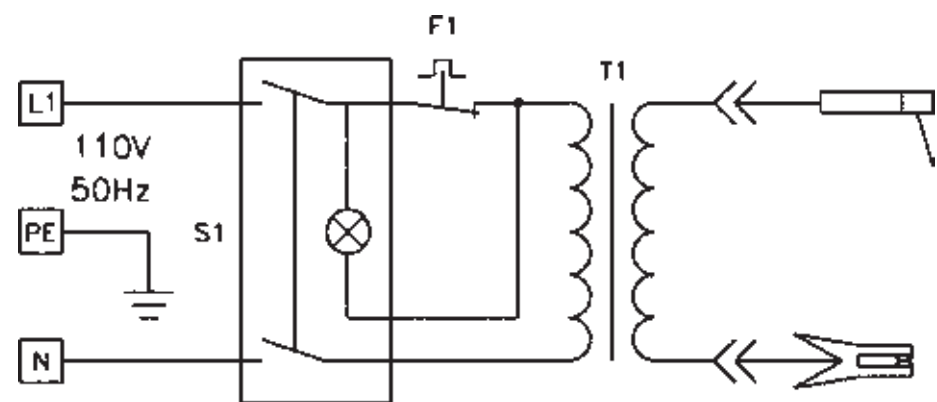

EASI ARC 115E

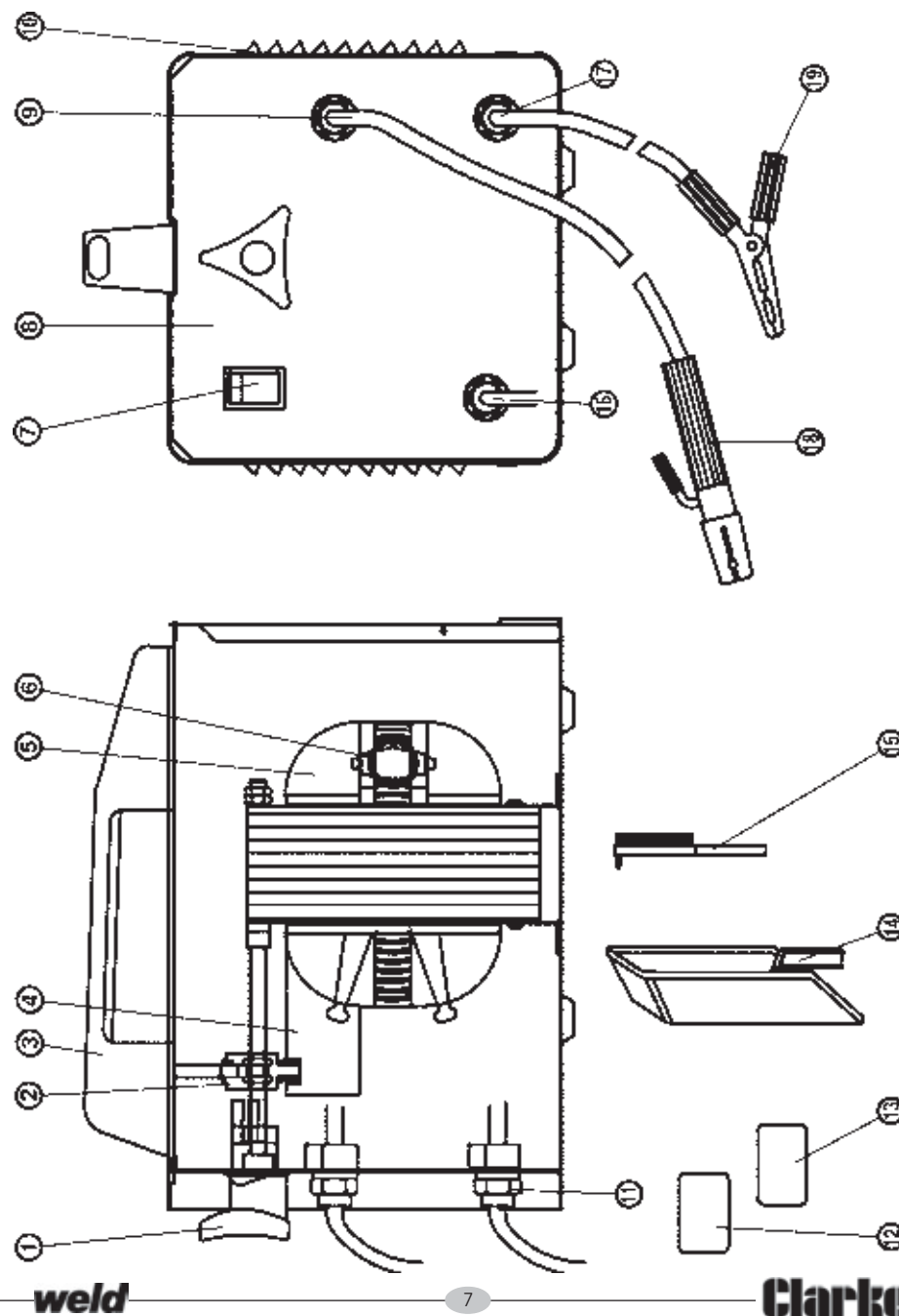

EASI ARC 160E

No.	Description	Part N o.
01	Hand-wheel	EM21800046
02	Shunt Yoke	EM33815001
03	Handle	EM21600003
04	Shunt	EM41415910
05	Transformer	EM44110158
06	Thermostat	EM22210016
07	Yellow Pilot-light Switch	EM22200022
08	Lower Panel	EM33700104
09	Welding Cable	EM43205003
10	Upper Panel	EM33705015
11	Cable Clamp	EM21605010
12	Transparent Glass	EM21905020
13	Dark Glass	EM21905021
14	Plastic Mask W/Handle	EM21905018
15	Hammer-brush	EM21905011
16	Input Cable	EM20220014
17	Earth Cable	EM43210021
18	Electrode Holder	EM22110011
19	Earth Clamp	EM22110005

EASI ARC 450TE

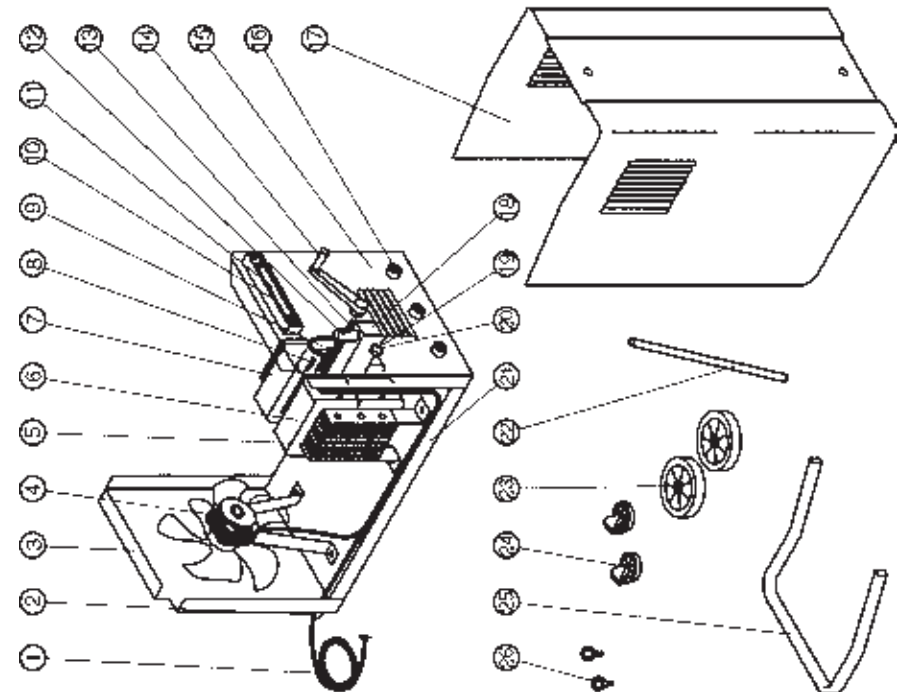
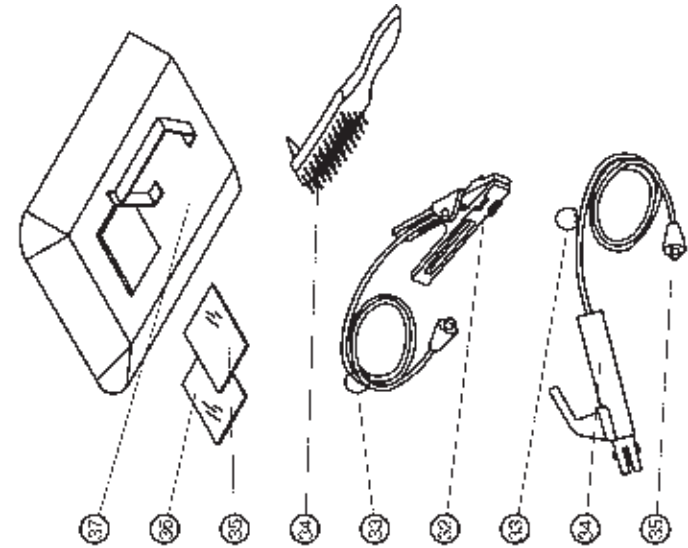

EASI ARC 450TE

No.	Description	Part N o.
01	Input Cable	EM20220101
02	Cable Clamp	EM21605011
03	Back Panel	EM33715033
04	Fan	EM22800009
05	Transformer	EM44110177
06	Primary Winding	EM44010302
07	Secondary Winding	EM44010290
08	Switch	EM22205110
09	Switch Knob	EM21690016
10	Scale Holder	EM21690180
11	Regulation Index	EM21690255
12	Shunt Yoke	EM33815009
13	Regulation Screw	EM33810037
14	Hand-wheel	EM21800018
15	Front Panel	EM33710196
16	Dinsel Socket	EM22100004
17	Upper Panel	EM33705096
18	Shunt	EM41415908
19	Green Pilot-lamp	EM22610015
20	Lamp Holder	EM22610018
21	Lower Panel	EM33700073
22	Wheels-axle	EM55200006
23	Rear Wheel	EM21625011
24	Rubber Pivoting Wheel	EM21625003
25	Handle	EM33725035
26	Lifting-eye	EM21070001
27	Carton Mask	EM21905019
28	Transparent Glass	EM21905020
29	Dark Glass	EM21905024

EASI ARC 160E

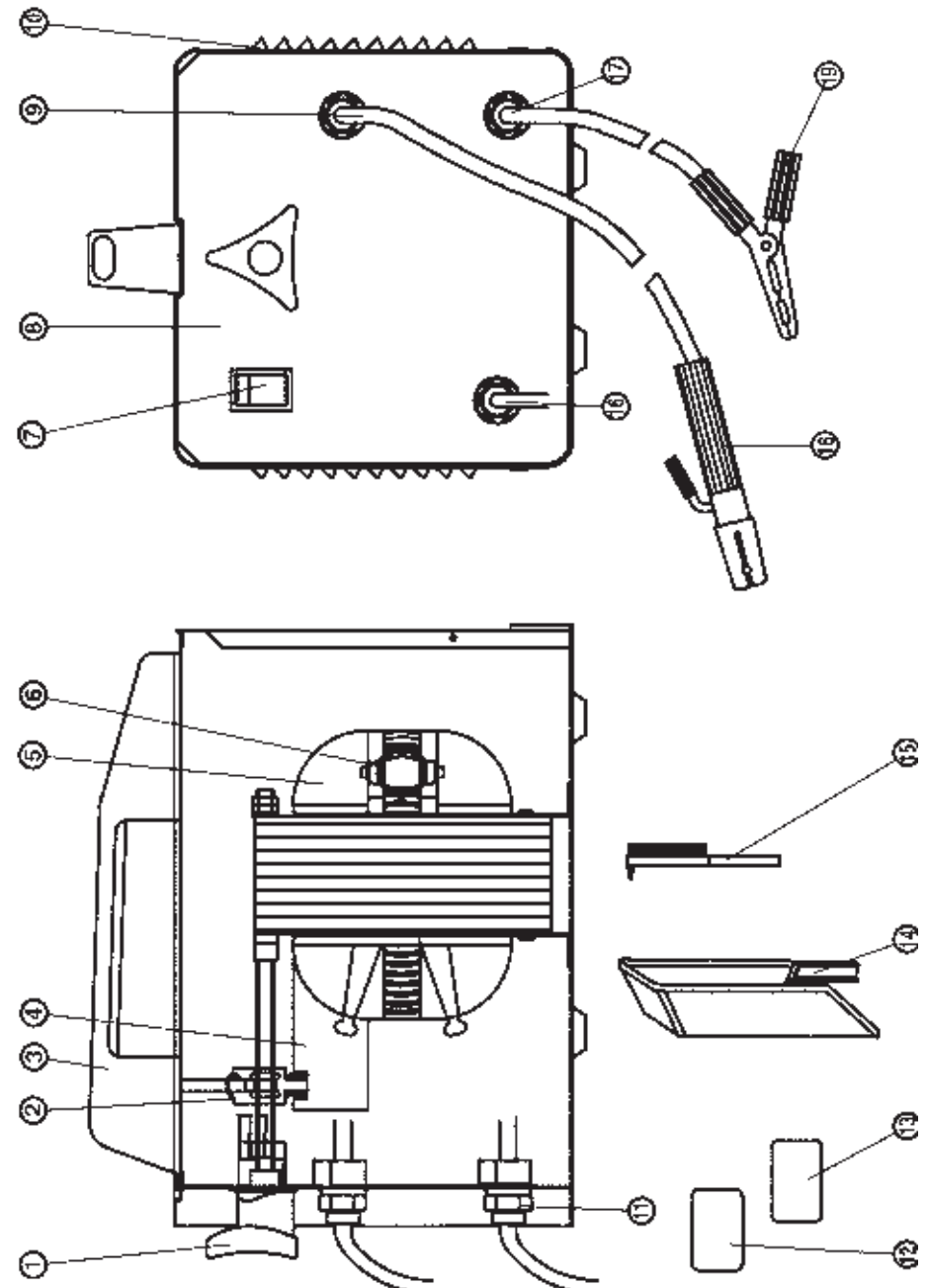

EASI ARC 190E

No.	Description	Part No.
01	Hand-wheel	EM21800046
02	Switch	EM22205009
03	Shunt Yoke	EM33815001
04	Shunt	EM41415911
05	Transformer	EM44110215
06	Thermostat	EM22210016
07	Lower Panel	M33700104
08	Switch Knob	EM21690179
09	Upper Panel	EM33705015
10	Handle	EM21600003
11	Hand-wheel	EM21800042
12	Orange Pilot-lamp	EM22610021
13	Insulating Washer	EM21615012
14	Plastic Mask	EM21905018
15	Transparent Glass	EM21905020
16	Dark Glass	EM21905021
17	Hammer-brush	EM21905011
18	Earth Clamp	EM22110007
19	Cable Clamp	EM21605010
20	Earth Cable	EM43210040
21	Pvc Input Cable	EM20220020
22	Electrode Holder	EM22110011
23	Welding Cable	EM43205029

EASI ARC 350TE

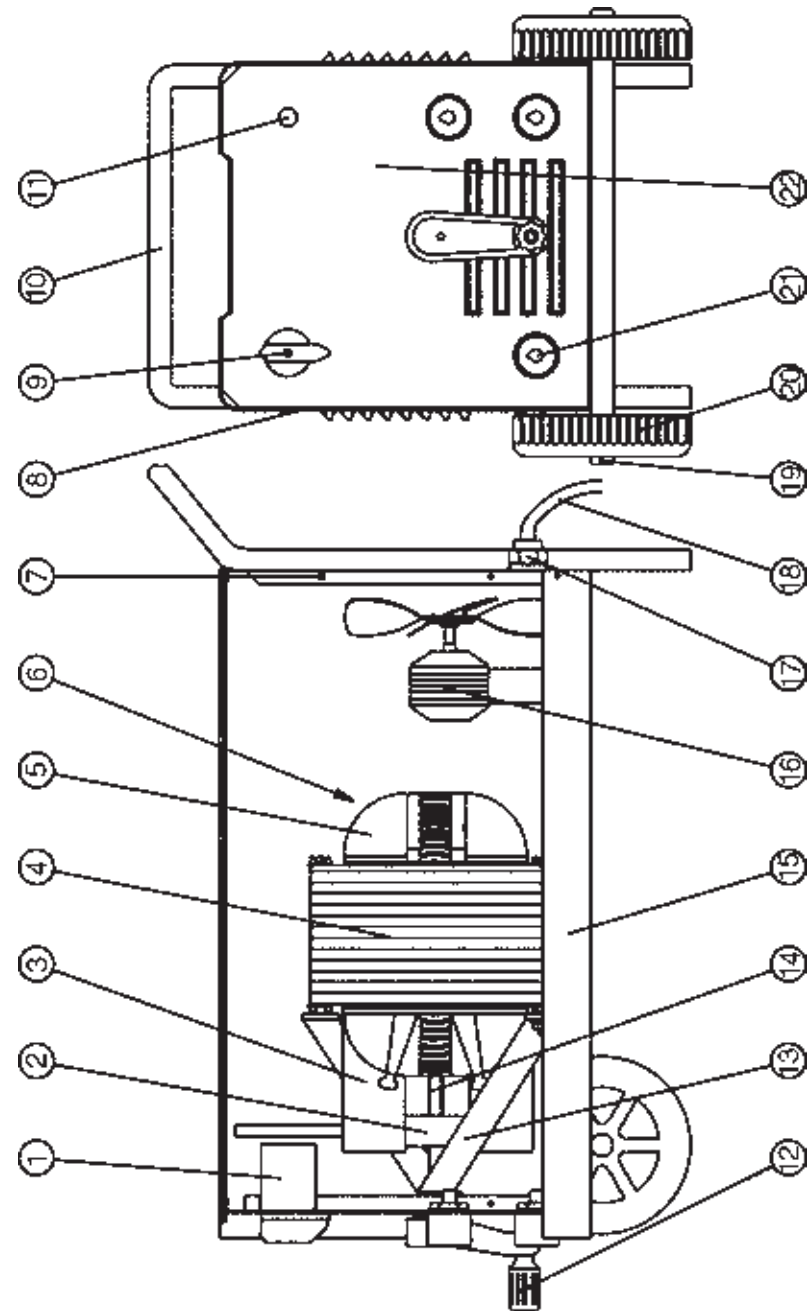

EASI ARC 350TE

No.	Description	Part No.
01	Switch	EM22205100
02	Shunt Yoke	EM33815006
03	Shunt	EM41415906
04	Transformer	EM44110053
05	Secondary Winding	EM44010080
06	Primary Winding	EM44010079
07	Back Panel	EM33715074
08	Upper Panel	EM33705242
09	Switch Knob	EM21690015
10	Handle	EM33725058
11	Green Pilot-lamp	EM22610008
12	Hand-wheel	EM21800017
13	Transformer Holder	EM33640010
14	Regulation Screw	EM33810002
15	Lower Panel	EM33700146
16	Fan	EM22800007
17	Cable Clamp	EM21605010
18	Input Cable	EM20220071
19	Wheels Axle	EM55200029
20	Wheel D.200	EM21625010
21	Dinse Socket	EM22100004
22	Front Panel	EM33710195
23	Carton Mask	EM21905019
24	Transparent Glass	EM21905020
25	Dark Glass	EM21905024
26	Hammer-brush	EM21905011
27	Earth Cable	EM43210023

EASI ARC 190E

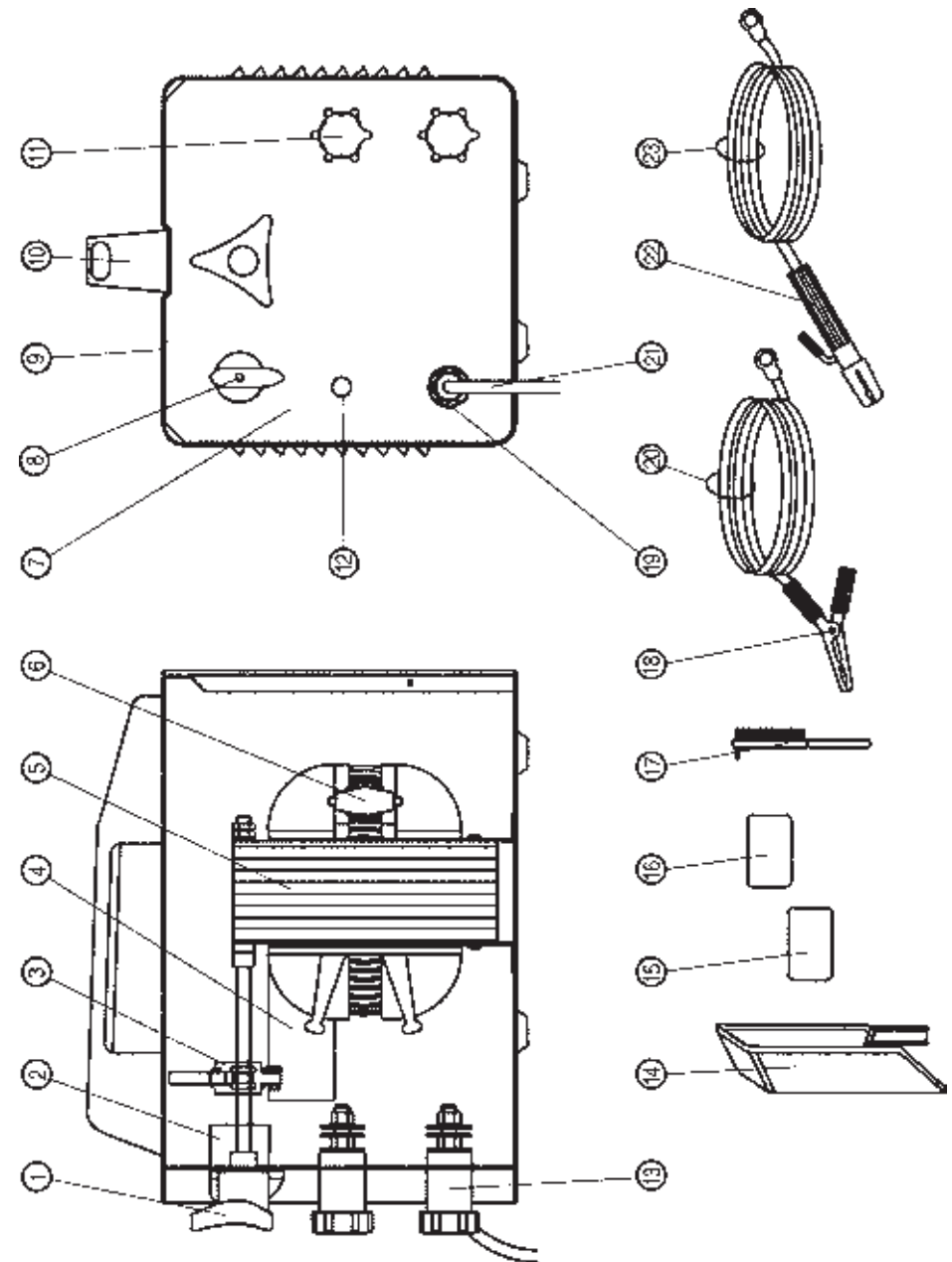

EASI ARC 145TE

No.	Description	Part No.
01	Hand-wheel	EM21800046
02	Shunt Yoke	EM33815001
03	Handle	EM21600003
04	Shunt	EM41415903
05	Transformer	EM44110213
06	Thermostat	EM22210016
07	Yellow Pilot-light Switch	EM22200022
08	Front Panel	EM33710060
09	Upper Panel	EM33705018
10	Cable Clamp	EM21605010
11	Lower Panel	EM33700033
12	Complete Fan	EM04600055
13	Input Cable	EM20220014
14	Earth Cable	EM43210021
15	Welding Cable	EM43205003
16	Transparent Glass	EM21905020
17	Dark Glass	EM21905021
18	Plastic Mask W/Handle	EM21905018
19	Hammer-brush	EM21905011
20	Earth Clamp	EM22110005
21	Electrode Holder	EM22110011

EASI ARC 300TE

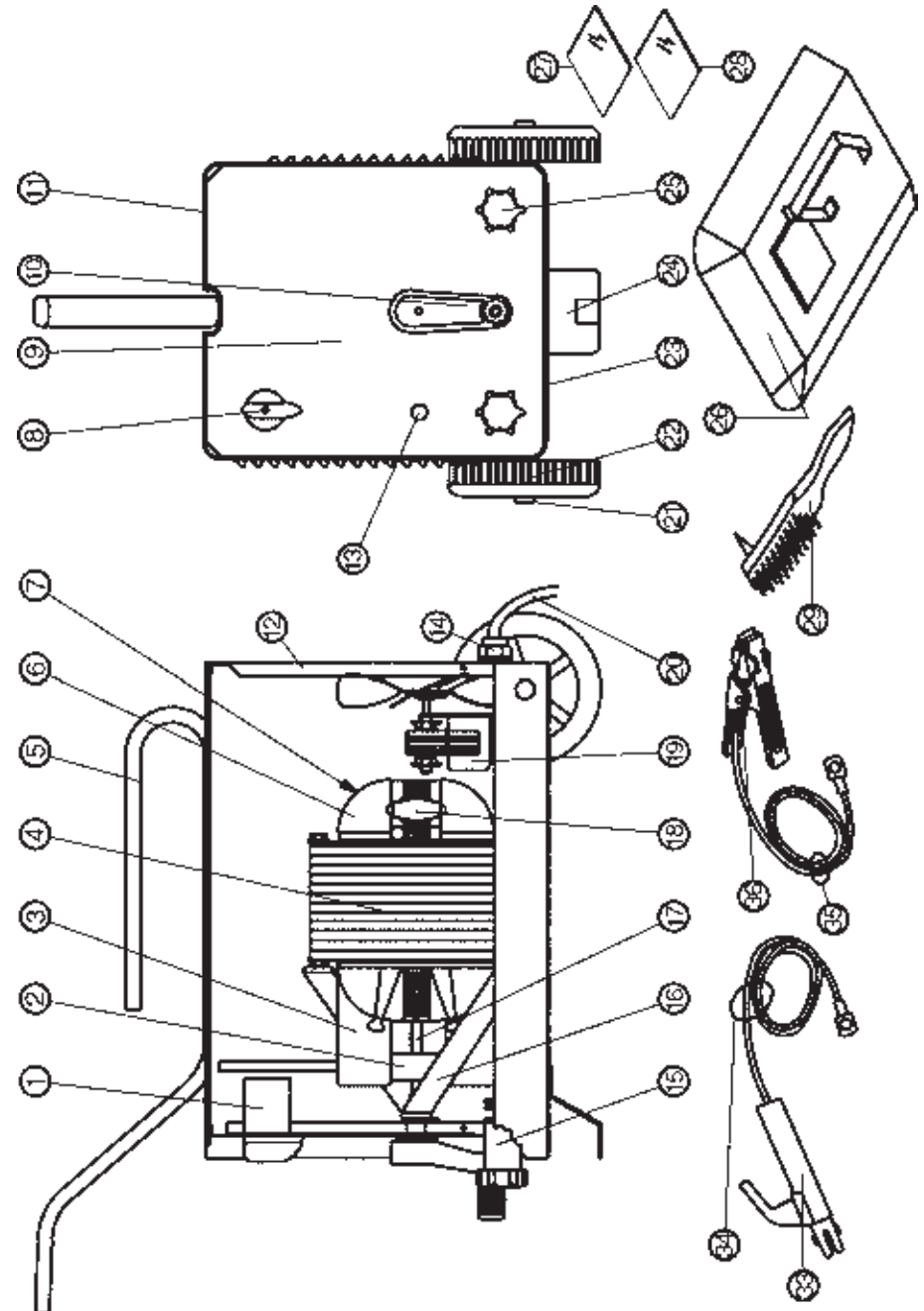

EASI ARC 260TE

No.	Description	Part No.
01	Switch	EM22205100
02	Shunt Yoke	EM33815006
03	Shunt	EM41415906
04	Transformer	EM44110025
05	Secondary Winding	EM44010045
06	Primary Winding	EM44010044
07	Back Panel	EM33715074
08	Upper Panel	EM33705242
09	Switch Knob	EM21690028
10	Handle	EM33725058
11	Green Pilot-lamp	EM22610008
12	Hand-wheel	EM21800017
13	Transformer Holder	EM33640010
14	Regulation Screw	EM33810002
15	Lower Panel	EM33700146
16	Fan	EM22800007
17	Cable Clamp	EM21605010
18	Input Cable	EM20220037
19	Wheels Axle	EM55200029
20	Wheel	EM21625010
21	Dinse Socket	EM22100004
22	Front Panel	EM33710195
23	Carton Mask	EM21905019
24	Transparent Glass	EM21905020
25	Dark Glass	EM21905024
26	Hammer-brush	EM21905011
27	Earth Cable	EM43210023
28	Earth Clamp	EM22110009
29	Welding Cable	EM43205015

EASI ARC 145TE

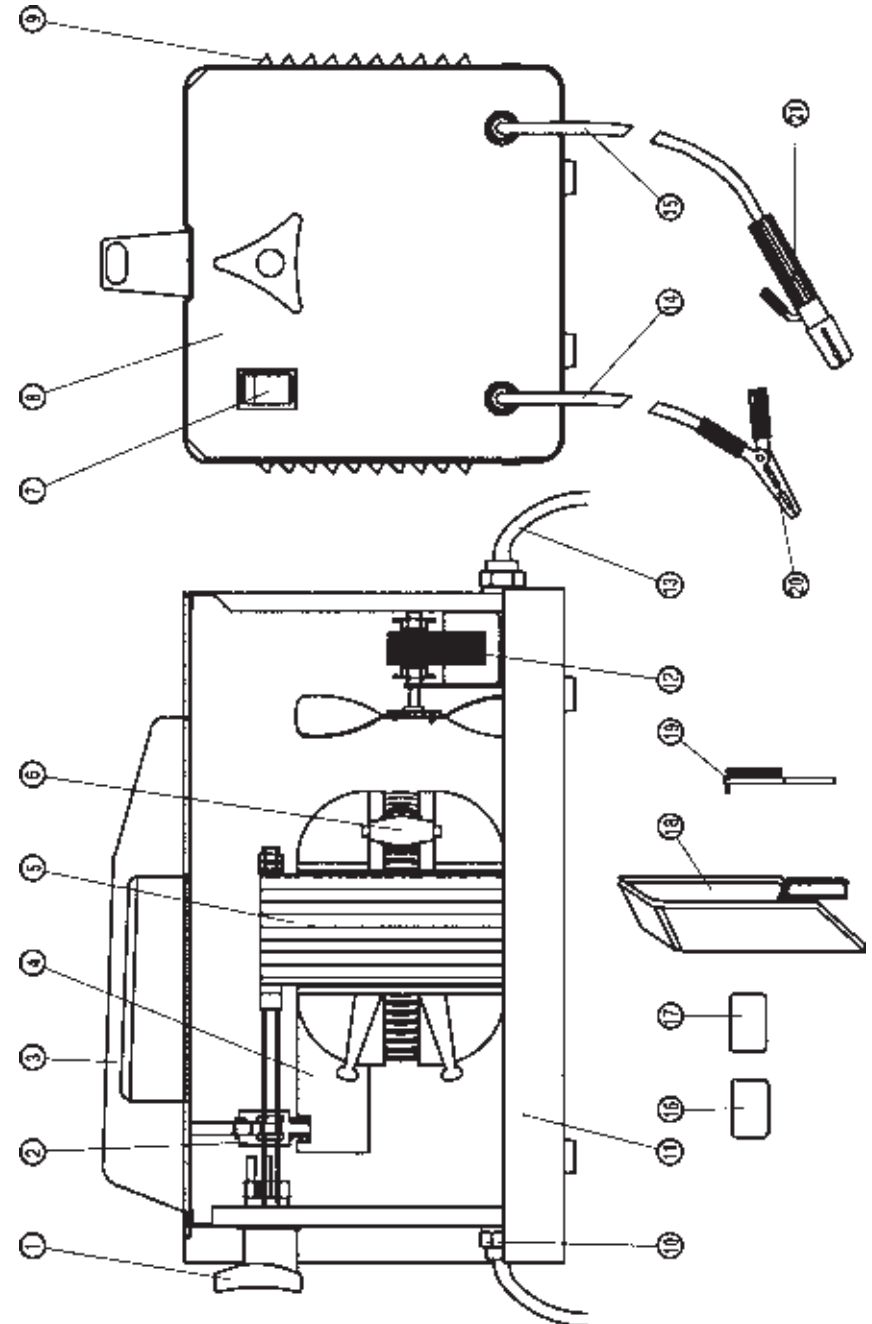

EASI ARC 165TE

No.	Description	Part No.
01	Hand-wheel	EM21800015
02	Switch Knob	EM21690015
03	Switch	EM22205026
04	Shunt Yoke	EM33815002
05	Shunt	EM41415907
06	Handle	EM21600003
07	Transformer	EME44110069
08	Thermostat	EM22210016
09	Orange Pilot-lamp	EM22610012
10	Front Panel	EM33710061
11	Upper Panel	EM33705021
12	6 Lobe Hand-wheel	EM21800042
13	Transparent Glass	EM21905020
14	Insulating Washer	EM21615012
15	Dark Glass	EM21905021
16	Regulation Screw +Washer	EM33810032
17	Plastic Mask W/Handle	EM21905018
18	Hammer-brush	EM21905011
19	Fan Kit	EM04600056
20	Earth Clamp	EM22110007
21	Cable Clamp	EM21605010
22	Pvc Input Cable	EM20220020
23	Earth Cable	EM43210040
24	Electrode Holder	EM22110011
25	Lower Panel	EM33700035
26	Welding Cable	EM43205029

EASI ARC 260TE

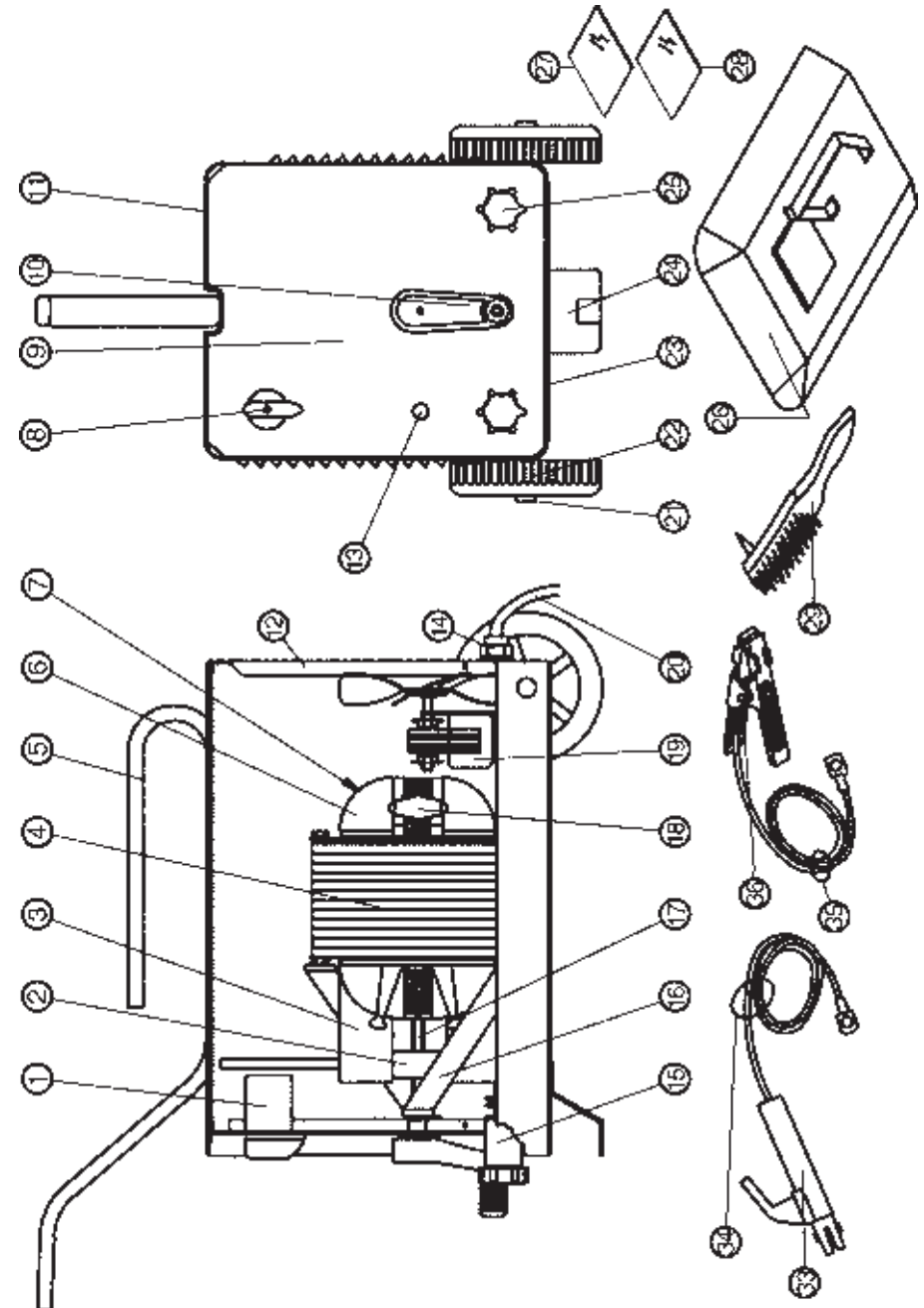

EASI ARC 260TE

No.	Description	Part No.
01	Switch	EM22205045
02	Shunt Yoke	EM33815006
03	Shunt	EM41415906
04	Transformer	EM44110041
05	Handle	EM33725005
06	Secondary Winding	EM44010099
07	Primary Winding	EM44010098
08	Switch Knob	EM21690015
09	Front Panel	EM33710025
10	Hand-wheel W/Handle	EM21800017
11	Upper Panel	EM33705022
12	Back Panel	EM33715007
13	Orange Pilot-lamp	EM22610012
14	Cable Clamp	EM21605010
15	Insulating French Washer	EM21615012
16	Transformer Holder	EM33640010
17	Regulation Screw	EM33810002
18	Thermostat	EM22210021
19	Fan	EM22800006
20	Input Cable	EM20220075
21	Wheels-axle	EM55200002
22	Wheel	EM21625007
23	Lower Panel	EM33700036
24	Foot	EM33740017
25	Hand-wheel	EM21800014
26	Carton Mask	EM21905019
27	Transparent Glass	EM21905020
28	Dark Glass	EM21905024
29	Hammer-brush	EM21905011
30	Earth Clamp	EM22110009

EASI ARC 165TE

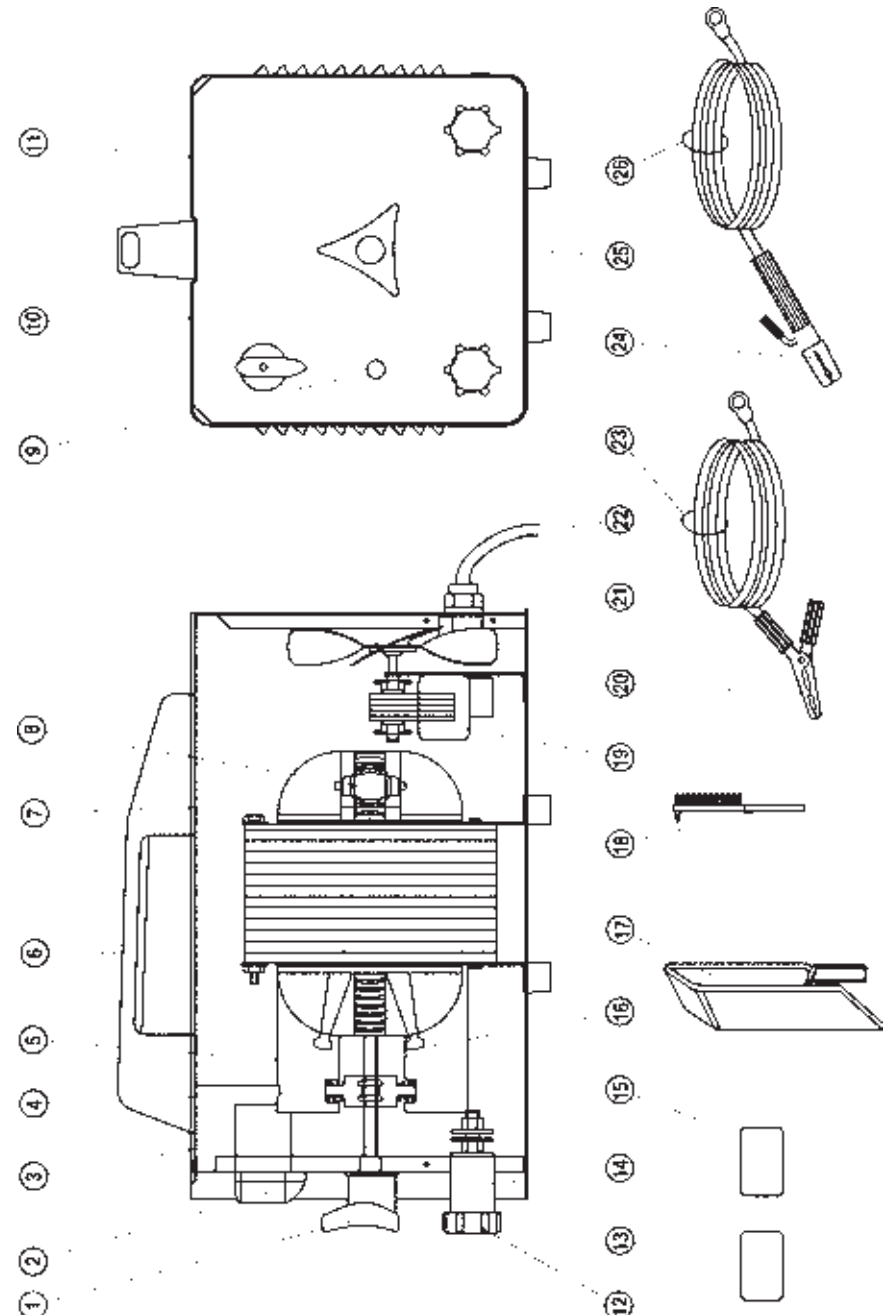

EASI ARC 190TE

No.	Description	Part N o.
01	Hand-wheel	EM21800015
02	Switch Knob	EM21690015
03	Switch	EM22205101
04	Shunt Yoke	EM33815002
05	Shunt	EM41415907
06	Handle	EM21600003
07	Transformer	EM44110011
08	Thermostat	EM22210016
09	Orange Pilot-lamp	EM22610012
10	Front Panel	EM33710061
11	Upper Panel	EM33705021
12	Hand-wheel	EM21800042
13	Transparent Glass	EM21905020
14	Insulating French Washer	EM21615012
15	Dark Glass	EM21905021
16	Regulation Screw	EM33810032
17	Carton Mask	EM21905019
18	Hammer-brush	EM21905011
19	Fan Kit	EM04600056
20	Earth Clamp	EM22110007
21	Grommet	EM21605010
22	PVC Input Cable	EM20220020
23	Earth Cable	EM43210040
24	Electrode Holder	EM22110011
25	Lower Panel	EM33700035
26	Welding Cable	EM43205029

EASI ARC 230TE

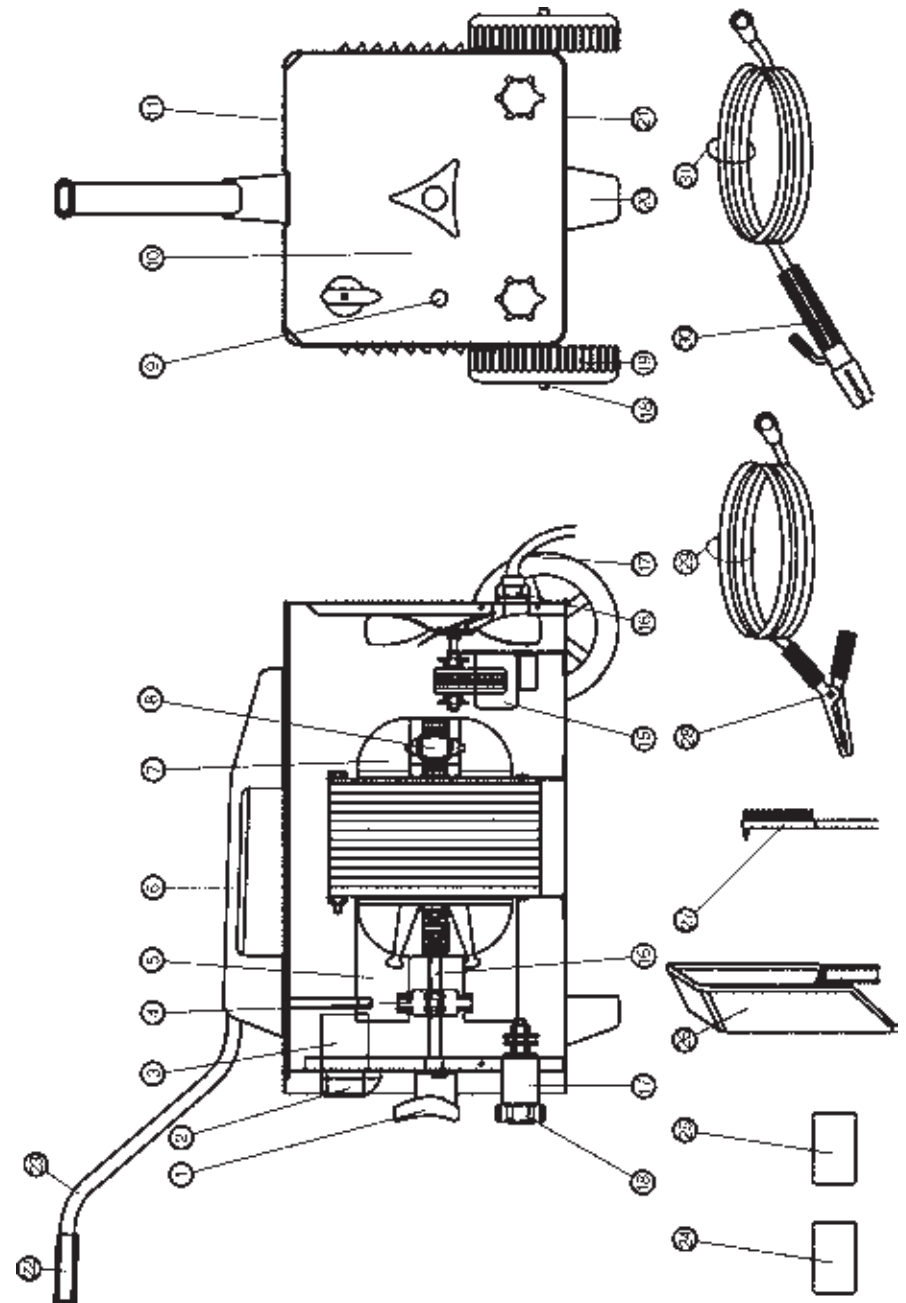

EASI ARC 230TE

No.	Description	Part No.
01	Hand-wheel	EM21800015
02	Switch Knob	EM21690015
03	Switch	EM22205101
04	Shunt Yoke	EM33815002
05	Shunt	EM41415907
06	Handle	EM21600003
07	Transformer	EM44110015
08	Thermostat	EM22210019
10	Front Panel	EM33710061
11	Upper Panel	EM33705021
12	Hand-wheel	EM21800042
13	Insulating Washer	EM21615012
14	Regulation Screw +Washer	EM33810032
15	Fan Kit	EM04600056
16	Cable Clamp	EM21605010
17	PVC Input Cable	EM20220020
18	Wheels-axle	EM55200014
19	Wheel	EM21625013
20	Plastic Foot	EM21610009
21	Lower Panel	EM33700035
22	Handle-extension Knob	EM21600006
23	Handle	EM33725015
24	Transparent Glass	EM21905020
25	Dark Glass	EM21905021
26	Carton Mask	EM21905019
27	Hammer-brush	EM21905011
28	Dinse Plug	EM22100003

EASI ARC 190TE

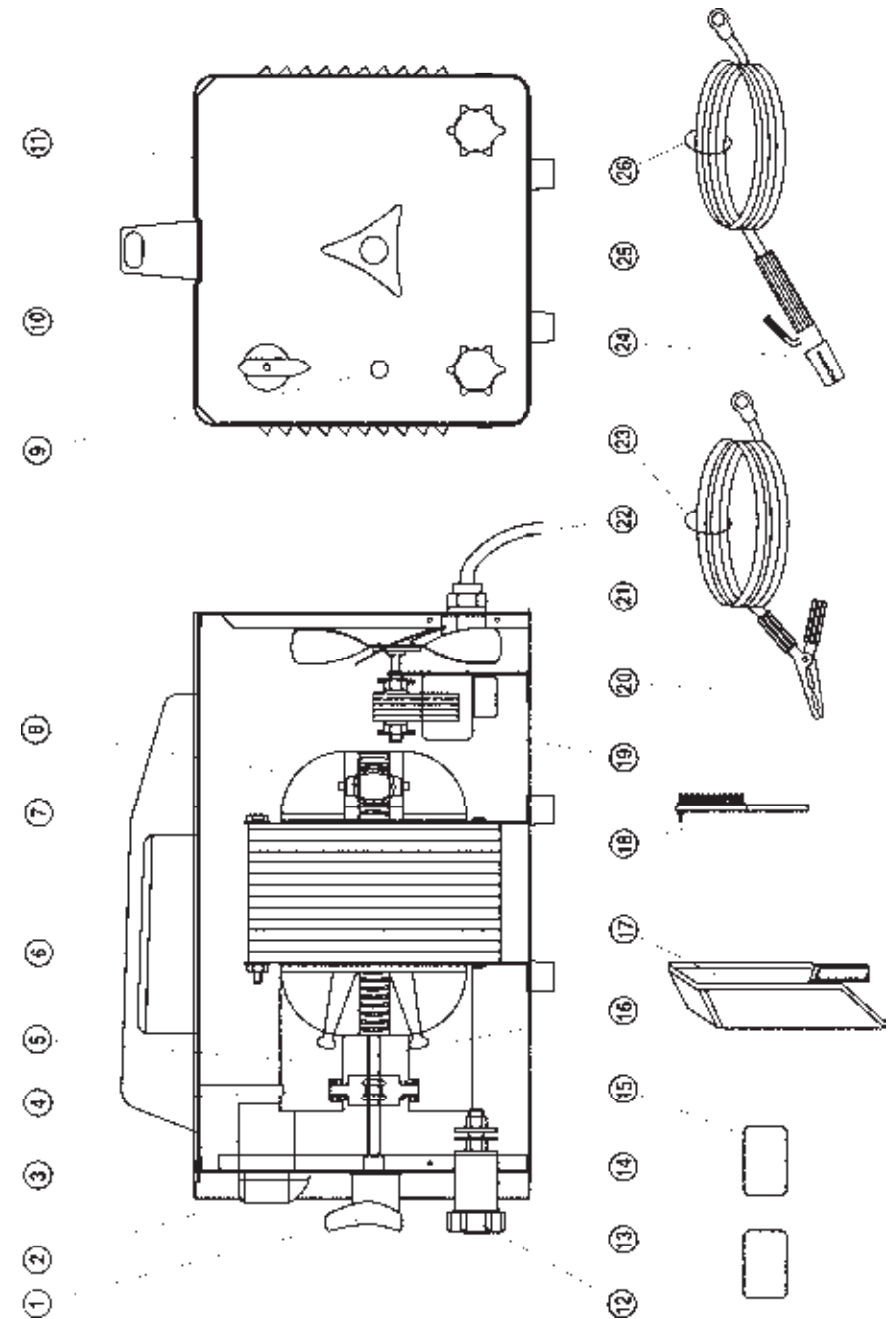

EASI ARC 145ED

No.	Description	Part No.
01	Hand-wheel	EM21800046
02	Switch	EM22205101
03	Shunt	EM41415903
04	Handle	EM21600003
05	Transformer	EM44110214
06	Thermostat	EM22210019
07	Switch Knob	EM21690015
08	Orange Pilot-lamp	EM22610012
09	Upper Panel	EM33705018
10	Cable Clamp	EM21605010
11	Shunt Yoke	EM33815001
12	Lower Panel	EM33700033
13	Pvc Input Cable	EM20220020
14	Earth Clamp	EM22110005
15	Earth Cable	EM43210021
16	Electrode Holder	EM22110011
17	Welding Cable	EM43205003
18	Front Panel	EM33710013
19	Dark Glass	EM21905021
20	Transparent Glass	EM21905020
21	Plastic Mask W/Handle	EM21905018
22	Hammer-brush	EM21905011

EASI ARC 145ED

